

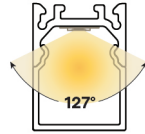

VERS-DROP-SK (10) FOR TUNABLE APPLICATIONS

24VDC Linear Fixtures - Suspended

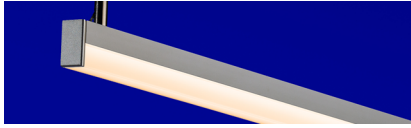

- 80 Suspension Kit configurations allow fixture to be seamlessly incorporated into any interior
- Create long, continuous lines of light with easy-to-use inline bracket connectors
- The lens sits proud of the fixture, allowing the most LED light engine options of any VERSatile fixture
- The lens creates a slim decorative line of light along the edge of the fixture
- Features integrated metal endcaps and durable anodized aluminum housings
- White Optics, an internal coating that results in greater lumen output, comes standard in all VERS fixtures.
- Consult factory for field assembly options

INFORMATION REQUIRED FOR LIGHTING SCHEDULE

| 1 | 2 | 3 | 4 | 5 | 6 |
|---------|-----------|-----|-------|------|-----------------|
| PRODUCT | WATTS/ FT | CCT | RATED | LENS | EXTERNAL LOUVER |
| | | | | | N/A |

ADDITIONAL INFORMATION REQUIRED TO ORDER

| 7 | 8 | 9 | 10 | 11 | 12 | 13 | 14 | 15 |
|--------------------|--------------------|---------------------|------------|-----------|----------|--------|-------------|----------------|
| WIRE INPUT/ OUTPUT | CONNECTOR/ WIRE IN | CONNECTOR/ WIRE OUT | WIRE COLOR | WIRE TYPE | MOUNTING | FINISH | LENGTH (IN) | EXACT/ OPTIMAL |
| | BW | CLS | SV | AWM | SK | | | |

Sample Part Number: **VERS-10-SK-DW-2.5HE-20/30-DRY-DF-N/A-S2-BW-CLS-SV-AWN-SK-WH-48"-E**

| | | | | | | | | |
|--|--|--|--|--|--|---|---|---|
| 1 PRODUCT VERS-10-SK-DW VERS-10-SK-DW- USA Select USA option for BAA and BABA projects. Only DRY ratings apply. LED engine is built with 3 wires requiring 0-10V, DMX or DALI control. Using DALI, DMX, or non QTL power supplies may double watts/ft. See following pages for compatible power supplies. | 2 WATTS/FT 1.5HE 1.5W/ft HE 2.5HE 2.5W/ft HE 4.0HE 4.0W/ft HE 1.5HE 1.5W/ft HE 2.5HE 2.5W/ft HE | 3 CCT 20/27 2000K/2700K 20/30 2000K/3000K 27/40 2700K/4000K 27/55 2700K/5500K 24/30 2400K/3000K 27/40 2700K/4000K | 4 RATED DRY IP20 DMP IP54 | 5 LENS DF Diffused PR Polar For representation of LED visibility, see Diode Visibility section on following pages. For beam angles, see Photometric Performance section on following pages. | 6 EXTERNAL LOUVER N/A No Louver | | | |
| 7 WIRE INPUT/OUTPUT SINGLE (Input Only) S2 Bottom Feed | 8 CONNECTOR/WIRE IN BW Bare Wire (Standard 36") BW: Standard length is 36", max length is 120". Request custom length by writing in part number next to BW (example: BW48) | 9 CONNECTOR/WIRE OUT CLS Closed End (No feed) | 10 WIRE COLOR SV Silver | 11 WIRE TYPE AWM Appliance Wiring Material | 12 MOUNTING SK Suspension Bracket | 13 FINISH ST Satin BK Black BZ Bronze WH White CU Custom Custom finishes require a longer lead time, consult factory. | 14 LENGTH (IN) Minimum length is 12", maximum length is 98" not including end caps. Contact us for lengths under 12". | 15 EXACT/OPTIMAL O Optimal Illumination E Exact Specified Length Exact fixtures match the exact length you specify, but they may have dim spots at the ends. Optimal fixtures are slightly shorter than the length specified, but provide full illumination from end to end. See Exact/Optimal Fixture Length charts. |

5 year warranty | Warranty only valid with QTL power supplies | Field modifications void warranty | Data subject to change, all data has +/- 5% tolerance



VERS-DROP-SK (10) FOR TUNABLE APPLICATIONS

24VDC Linear Fixtures - Suspended

1 PRODUCT - DIMENSIONS

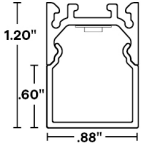

Profile with lens

2 DELIVERED LUMENS

[Calculated L70 = 70000 hrs]
Tested with VERS-10-SK-WD-**-DRY

| | 6.0 W/FT | | | |
|----|----------|-----|-------|-----|
| | 2700K | | 3000K | |
| | LM/FT | CRI | LM/FT | CRI |
| PR | 316 | 97 | 322 | 97 |
| DF | 300 | 97 | 304 | 97 |

[Calculated L70 = 70000 hrs]
Tested with VERS-10-SK-DW-**-DRY

| | 2.5HE W/FT | | | | | | | | | |
|----|------------|-----|-------|-----|-------|-----|-------|-----|-------|-----|
| | 2000K | | 2700K | | 3000K | | 4000K | | 5500K | |
| | LM/FT | CRI | LM/FT | CRI | LM/FT | CRI | LM/FT | CRI | LM/FT | CRI |
| PR | 172 | 93 | 185 | 98 | 205 | 98 | 206 | 97 | 218 | 97 |
| DF | 161 | 93 | 176 | 98 | 193 | 98 | 195 | 98 | 203 | 97 |

5 DIODE VISIBILITY



DF - Diffused lens

PR - Polar lens

PHOTOMETRIC PERFORMANCE

Nominal beam spread shown, beam spread varies based on light engine. For more detailed information, see photometric data.

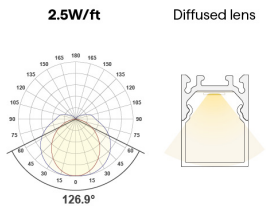

TEMPERATURE RATINGS

| | | DW 1.5 HE W/FT | | | | DW 2.5 HE W/FT | | | |
|-----|----------------------------------|--|-------|---------------------------------------|-------|--|-------|---------------------------------------|-------|
| | | Q-Tran power supply other than DALI, DMX | | DALI, DMX, or non-Q-Tran power supply | | Q-Tran power supply other than DALI, DMX | | DALI, DMX, or non-Q-Tran power supply | |
| | | Min | Max | Min | Max | Min | Max | Min | Max |
| DRY | Ambient Operating Temp - Surface | -4°F | 145°F | -4°F | 135°F | -4°F | 135°F | -4°F | 120°F |
| DMP | Ambient Operating Temp - Surface | -4°F | 140°F | -4°F | 130°F | -4°F | 130°F | -4°F | 115°F |
| WET | Ambient Operating Temp - Surface | -4°F | 140°F | -4°F | 130°F | -4°F | 130°F | -4°F | 115°F |



VERS-DROP-SK (10) FOR TUNABLE APPLICATIONS

24VDC Linear Fixtures - Suspended

7 WIRE INPUT/ OUTPUT

SINGLE (Input only)

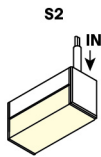

CONFIGURATION OPTIONS

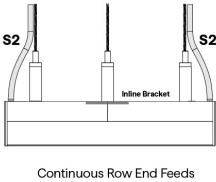
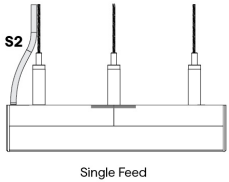

8 / 9 CONNECTOR/WIRE - IN/OUT

Connector/Wire In or Out not needed to specify product.

BW

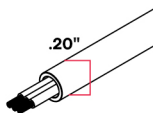

Bare Wire 36" | 22 AWG
Clear outer jacket, metal shield

10 WIRE COLOR



Silver

12 MOUNTING

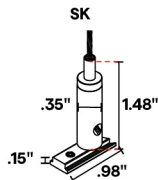

Suspension Bracket

2 required up to 6' lengths;
additional support required
between 6' to 8'

13 FINISH

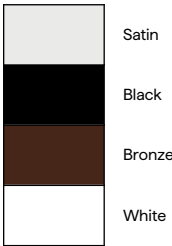

Satin

Black

Bronze

White

Custom finishes require a longer
lead time, consult factory



VERS-DROP-SK (10) FOR TUNABLE APPLICATIONS

24VDC Linear Fixtures - Suspended

15 EXACT/OPTIMAL FIXTURE LENGTH

Exact fixtures are the exact length specified. Optimal fixtures' length is rounded down based on LED cut points to allow the fixture to be illuminated end to end. For runs with multiple fixtures that need to fill a specific length, it's recommended to order all optimal fixtures with an exact fixture at the end of the run.

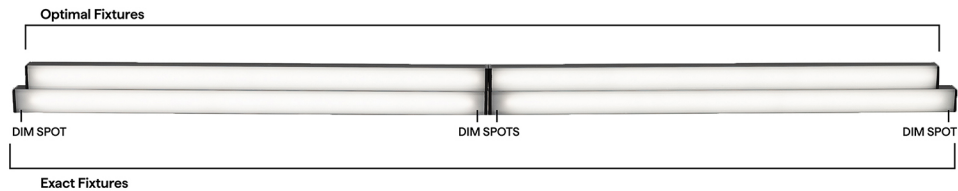

DW-HE DRY, DMP LENGTHS BY INCH

Available in any length in between 24" and 98" not including end caps, chart below shows example lengths. Exact fixtures are the length specified. Optimal fixtures' length is rounded down with illumination end to end. All fixtures' tolerance is +0 - 1/8". Consult factory for lengths under 24".

EXACT LENGTH

| Requested Length | Potential dim spot on either end of fixture |
|------------------|---|
| 12" | 1" |
| 13" | 0.5" |
| 14" | 1" |
| 15" | 0.5" |
| 16" | 1" |
| 17" | 0.5" |
| 18" | 1" |
| 19" | 0.5" |
| 20" | 1" |
| 21" | 0.5" |
| 22" | 1" |
| 23" | 0.5" |
| 24" | 1" |
| 36" | 1" |
| 48" | 1" |
| 60" | 1" |
| 72" | 1" |
| 84" | 1" |
| 96" | 1" |

OPTIMAL LENGTH: highlighted rows are closest to requested nominal length

| Requested Nominal Length | <div>S2 S2 </div> |
|--------------------------|---------------------------|
| 12" | 10.59" |
| 13" | 12.59" |
| 14" | 12.59" |
| 15" | 14.59" |
| 16" | 14.59" |
| 17" | 16.59" |
| 18" | 16.59" |
| 19" | 18.59" |
| 20" | 18.59" |
| 21" | 20.59" |
| 22" | 20.59" |
| 23" | 22.59" |
| 24" | 22.59" |
| 36" | 34.59" |
| 48" | 46.59" |
| 60" | 58.59" |
| 72" | 70.59" |
| 84" | 82.59" |
| 96" | 94.59" |

COMPATIBLE POWER SUPPLIES

See power supplies cut sheets for more information. Data subject to change, all data has +/- 5% tolerance.

| DIM TO LEVEL | INDOOR |
|--------------|---|
| | DW-HE Tunable Applications |
| 0.1% | QT-CAB-eLED+DALI-DT6 QT-CAB-eLED+DALI-DT8 QT-CAB-eLED+DALI-DT8-AWN QT-CAB-eLED+TW QT-CAB-eLED+TW-AWN QTM-eLED+DALI-DT6 QTM-eLED+DALI-DT8 QTM-eLED+DALI-DT8-AWN QTM-eLED+TW QTM-eLED+TW-AWN QZ-DMX |
| 1% | QZ-DALI-DT8 |
| 10% | Non-Dim Power Supply with TW App Dongle |



VERS-DROP-SK (10) FOR TUNABLE APPLICATIONS

24VDC Linear Fixtures - Suspended

| DIMMING PROTOCOL | INDOOR |
|---|---|
| | DW-HE Tunable Applications |
| 0-10V | QT-CAB-eLED+TW QT-CAB-eLED+TW-AWN QTM-eLED+TW QTM-eLED+TW-AWN |
| Lutron Athena | QT-CAB-eLED+DALI-DT8-AWN QT-CAB-eLED+TW-AWN QTM-eLED+DALI-DT8-AWN QTM-eLED+TW-AWN |
| DMX LED wattage must be doubled for DW-HE products | QZ-DMX |
| DALI-2: DT6 LED wattage must be doubled for DW-HE products except for AWN | QT-CAB-eLED+DALI-DT6 QTM-eLED+DALI-DT6 |
| DALI-2: DT8 LED wattage must be doubled for DW-HE products except for AWN | QT-CAB-eLED+DALI-DT8 QT-CAB-eLED+DALI-DT8-AWN QTM-eLED+DALI-DT8 QTM-eLED+DALI-DT8-AWN QZ-DALI-DT8 |
| SCENE App Dimmed | Non-Dim Power Supply with TW App Dongle |

COMPATIBLE WIRING ACCESSORIES

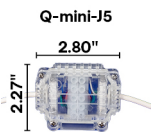

UL Listed, miniature junction box, DRY/DMP (WET rated with silicone)

COMPATIBLE CONTROL ACCESSORIES

SCENE APP DONGLE



Wi-Fi or Bluetooth Connectivity

COMPATIBLE APPS

NFC APP



Read and write DMX addresses and adjust voltage



VERS-SK

Linear Fixtures - Suspended



- Shop drawings required for run lengths over 8ft
- If no suspension length provided, 36" is standard
- Suspension cable maximum length: 120"
- Suspension cable is field cuttable
- Suspended fixtures over 6ft require additional suspension points. 8ft lengths will bow 0.25" in middle without additional support.
- Any run length over 8' requires inline brackets
- Consult factory for power over aircraft
- Consult factory for custom color of canopy
- Lag Screw is for mounting into drywall, wood, or other types of finished ceilings for non-feed mounting only

POWER FEED SUSPENSION KIT

| 1 | 2 | 3 | 4 | 5 | 6 | 7 |
|---------|------|--------------|-------------|---------------|-------------|------------------------------|
| PRODUCT | FEED | CANOPY SHAPE | CANOPY SIZE | CANOPY FINISH | APPLICATION | SUSPENSION CABLE LENGTH (IN) |
| SK | | | 5" | | | |

Sample Part Number: **SK-SF-RD-5"-WH-JB-36"**

| 1 | 2 | 3 | 4 | 5 | 6 | 7 |
|---------|-----------|-----------------|-------------|----------------------|--|------------------------------|
| PRODUCT | FEED | CANOPY SHAPE | CANOPY SIZE | CANOPY FINISH | APPLICATION | SUSPENSION CABLE LENGTH (IN) |
| SK | SF Single | RD Round Square | 5" | WH White BK Black | JB Junction Box TB T-Bar Mount JB - mounting bracket only, junction box not included TB - mounting bracket and junction box | 36" 120" |

NON-FEED SUSPENSION KIT

| 1 | 2 | 3 | 4 | 5 | 6 | 7 |
|---------|------|--------------|-------------|---------------|-------------|------------------------------|
| PRODUCT | FEED | CANOPY SHAPE | CANOPY SIZE | CANOPY FINISH | APPLICATION | SUSPENSION CABLE LENGTH (IN) |
| SK | NF | | | | | |

Sample Part Number: **SK-SF-RD-5"-WH-JB-36"**

| 1 | 2 | 3 | 4 | 5 | 6 | 7 |
|---------|------------|-----------------|--------------------|--|---|------------------------------|
| PRODUCT | FEED | CANOPY SHAPE | CANOPY SIZE | CANOPY FINISH | APPLICATION | SUSPENSION CABLE LENGTH (IN) |
| SK | NF No Feed | RD Round Square | 2" 5" 5" | WH White BK Black WH White BK Black | TB T-Bar Mount LS Lag Screw JB Junction Box Mounting bracket only, junction box not included | 36" 120" |

KIT CONTENTS

- 1/16" Steel suspension cable – 36" standard
- Selected canopy
- Cable Gripper
- Cable Coupler

JBOX

- Bracket to mount to junction box (junction box not included)
- Wire strain relief
- Ties for securing electrical cable to suspension cable

T-BAR – feed

- Includes junction box specifically designed for T-BAR applications
- Bracket to mount to junction box
- Wire strain relief
- Ties for securing electrical wire to suspension cable

T-BAR – non-feed

- Bracket to mount to T-BAR (no junction box)

LAG SCREW – non-feed only

- Double ended screw, with a wood thread side and machine thread side
- One piece cable coupler



VERS-SK

Linear Fixtures - Suspended

3 CANOPY OPTIONS

RD - 2" - NF

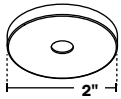

Round
2"
No Feed

SQ - 2" - NF

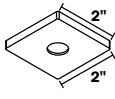

Square
2"
No Feed

RD - 5" - NF

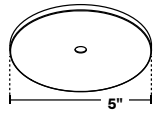

Round
5"
No Feed

SQ - 5" - NF

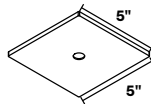

Square
5"
No Feed

RD - 5" - SF

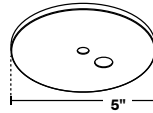

Round
5"
Single Feed

SQ - 5" - SF

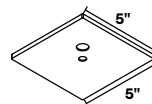

Square
5"
Single Feed

5 CANOPY FINISH



White

Black

JOINTS/CONNECTORS

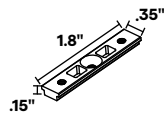

Inline Bracket

6 APPLICATION

TB
Power Feed Kit

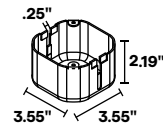

T-Bar Junction Box

TB
Non-Feed Kit



T-Bar Clip

LS



Lag Screw

KIT HARDWARE

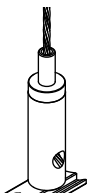

Cable Gripper



Cable Coupler



VERS-SK

Linear Fixtures - Suspended

MOUNTING

- Maximum single fixture length: 98"
- Suspended fixtures over 6ft require additional suspension points. 8ft lengths will bow 0.25" in middle without additional support.
- Shop drawings required for run lengths over 8ft

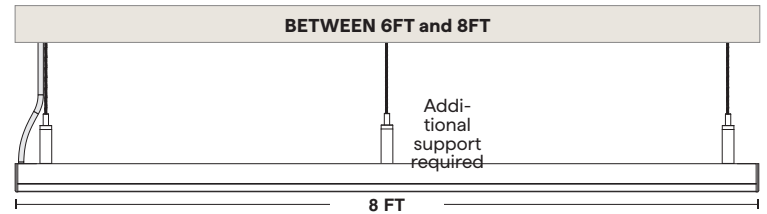
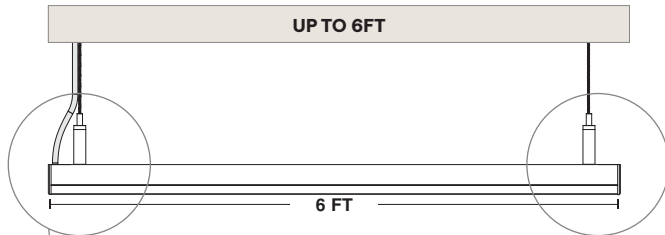

Power Feed Suspension

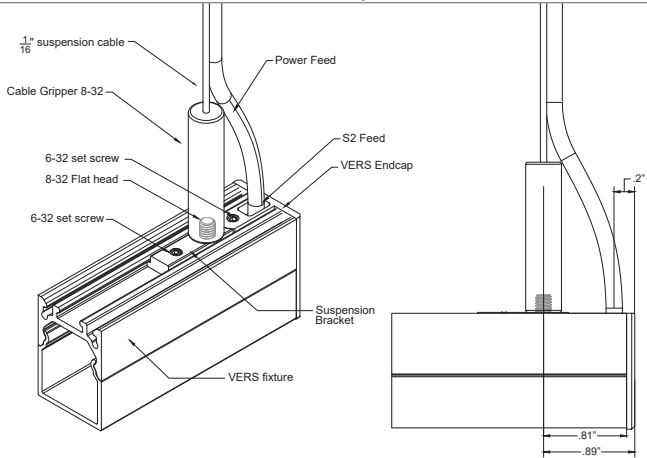

Non-Feed Suspension

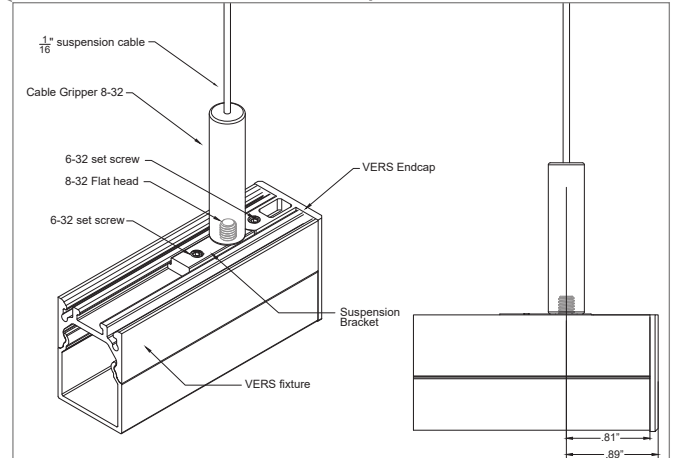



VERS-SK

Linear Fixtures - Suspended

MOUNTING

- Maximum single fixture length: 98"
- Suspended fixtures over 6ft require additional suspension points. 8ft lengths will bow 0.25" in middle without additional support.
- Shop drawings required for run lengths over 8ft

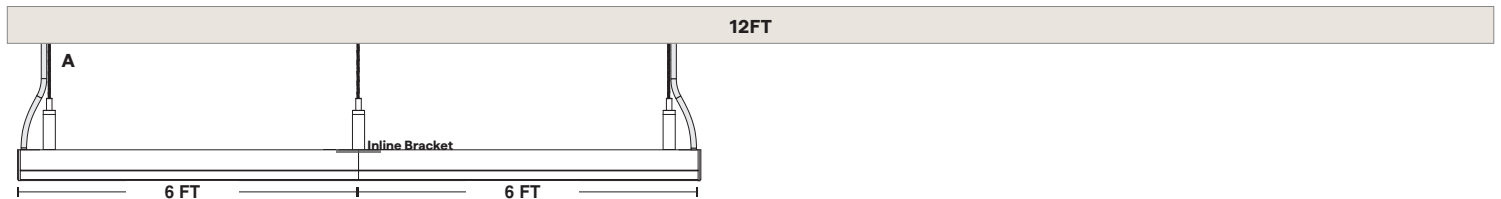

Part number example for a suspended VERS-O1 dry rated static white fixture with a diffused lens in 1.5W/ft, 3000K, in a satin finish:

A VERS-10-SK-SW-1.5-30-DRY-DF-N/A-S2-BW-CLS-SV-AWM-SK-ST-144" (1X)
SK-SF-RD-5"-WH-JB-36" (2X)
SK-NF-RD-5"-WH-JB-36" (1X)

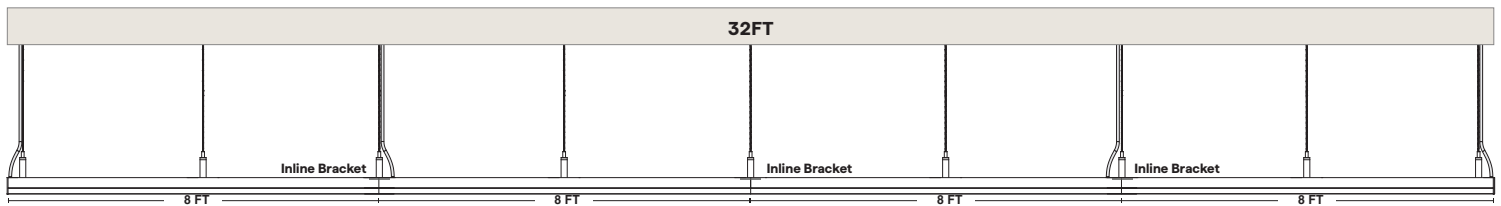
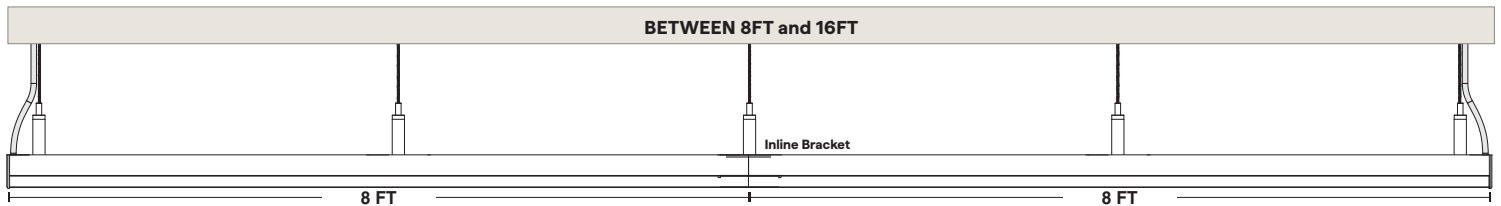



VERS-SK

Linear Fixtures - Suspended

SUSPENSION T-BAR POWER FEED ASSEMBLY

SK-SF-RD-5-**-TB-36

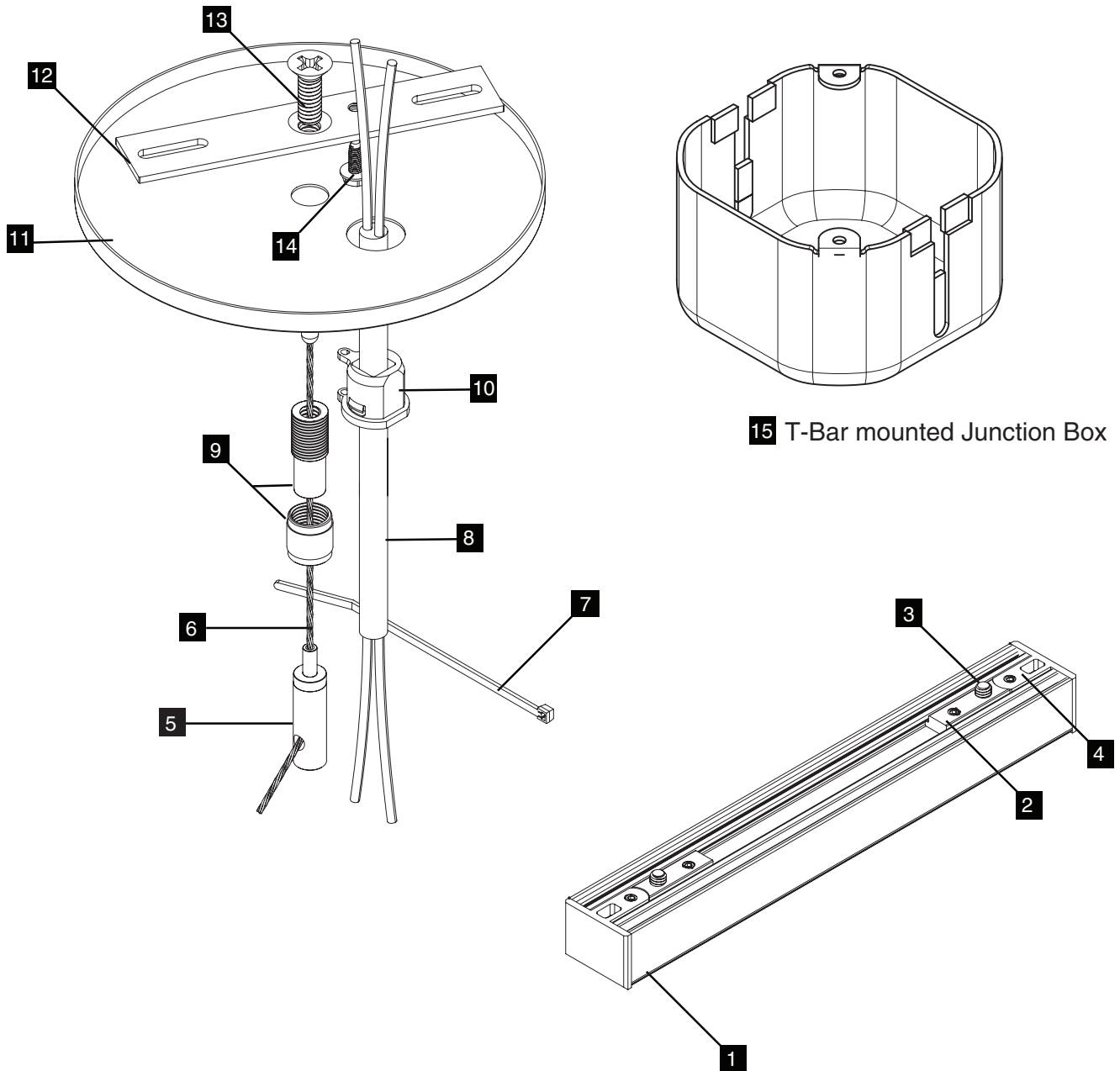

VERS SUSPENSION COMPONENTS

- | | | | | | | | | | | | | | |
|---|-----------|---|--------------------|----|---------------|----|--------|----|---------------|----|-------------|----|--------------|
| 1 | VERS | 2 | Suspension Bracket | 3 | 8-32 Screw | 4 | Endcap | 5 | Cable Gripper | 6 | 1/16" Cable | 7 | Tie |
| 8 | Lead Wire | 9 | Cable Coupler | 10 | Strain Relief | 11 | Canopy | 12 | Crossbar | 13 | 1/4"-20 | 14 | Ground Screw |



VERS-SK

Linear Fixtures - Suspended

SUSPENSION POWER FEED ASSEMBLY - TO MOUNT TO JUNCTION BOX*

*JUNCTION BOX NOT INCLUDED

SK-SF-RD-5-**-JB-36

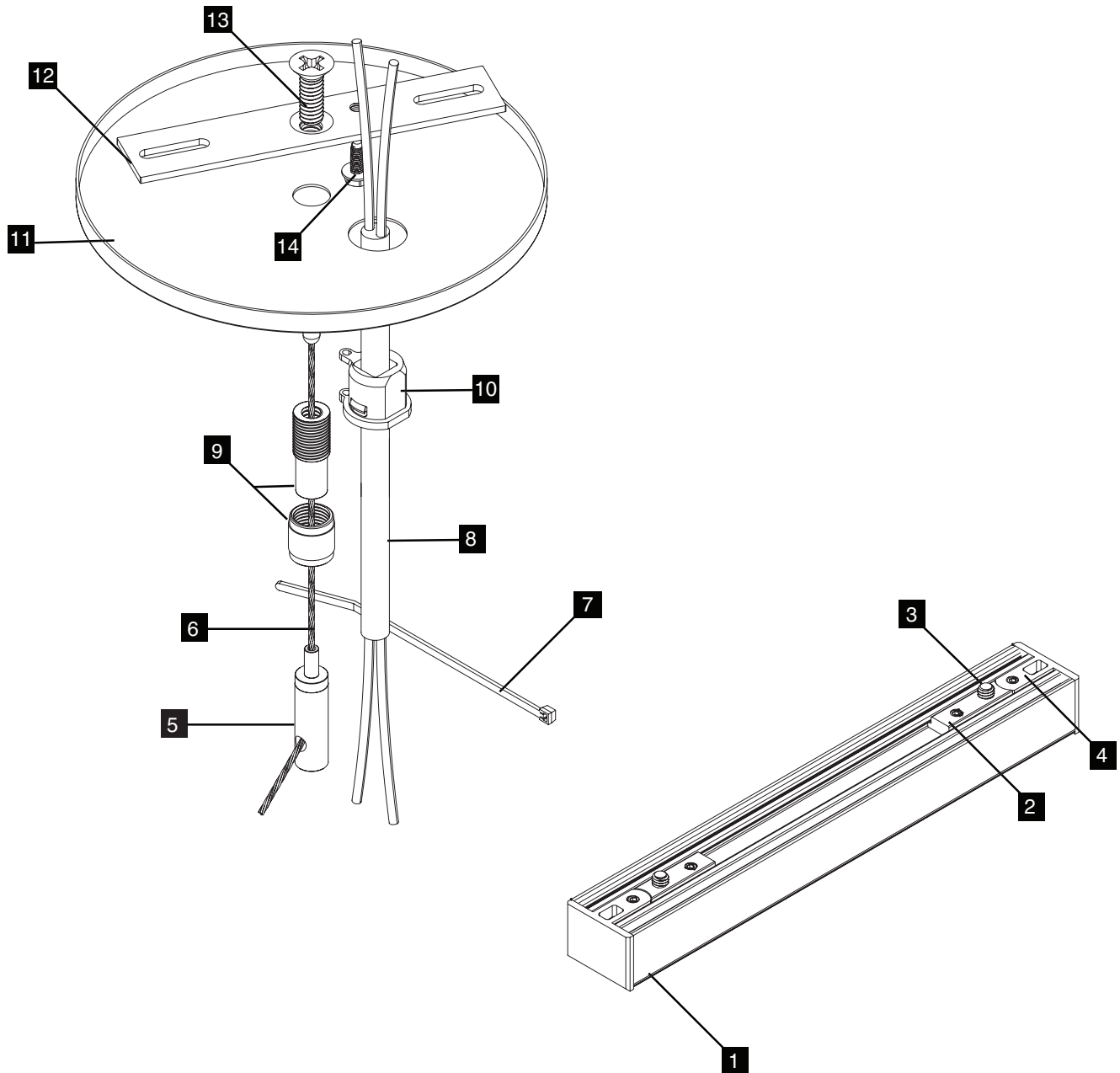

VERS SUSPENSION COMPONENTS

- | | | | | | | | | | | | | | |
|---|-----------|---|--------------------|----|---------------|----|--------|----|---------------|----|-------------|----|--------------|
| 1 | VERS | 2 | Suspension Bracket | 3 | 8-32 Screw | 4 | Endcap | 5 | Cable Gripper | 6 | 1/16" Cable | 7 | Tie |
| 8 | Lead Wire | 9 | Cable Coupler | 10 | Strain Relief | 11 | Canopy | 12 | Crossbar | 13 | 1/4"-20 | 14 | Ground Screw |



VERS-SK

Linear Fixtures - Suspended

SUSPENSION T-BAR NON-FEED ASSEMBLY

SK-NF-RD-2-NF-* -TB-36

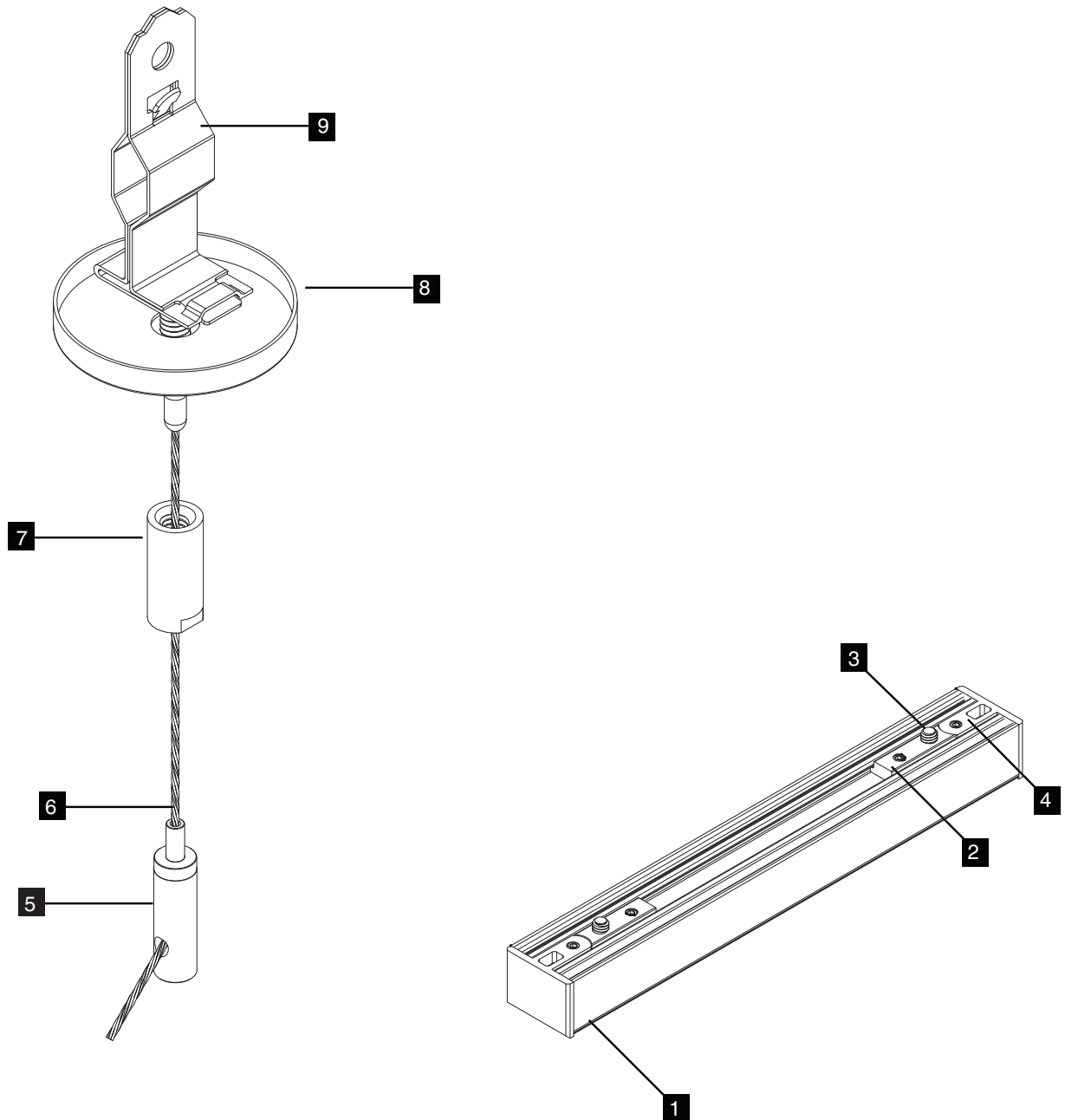

NON-POWERED FEED KIT

| | | | | |
|----------------------|-----------------------------|---------------------|---------------------|------------------------|
| 1 VERS | 2 Suspension Bracket | 3 8-32 Screw | 4 Endcap | 5 Cable Gripper |
| 6 1/16" Cable | 7 Cable Coupler | 8 Canopy | 9 T-Bar Clip | |



VERS-SK

Linear Fixtures - Suspended

LAG SCREW NON-FEED ASSEMBLY

SK-NF-RD-2-NF-*-LS-36

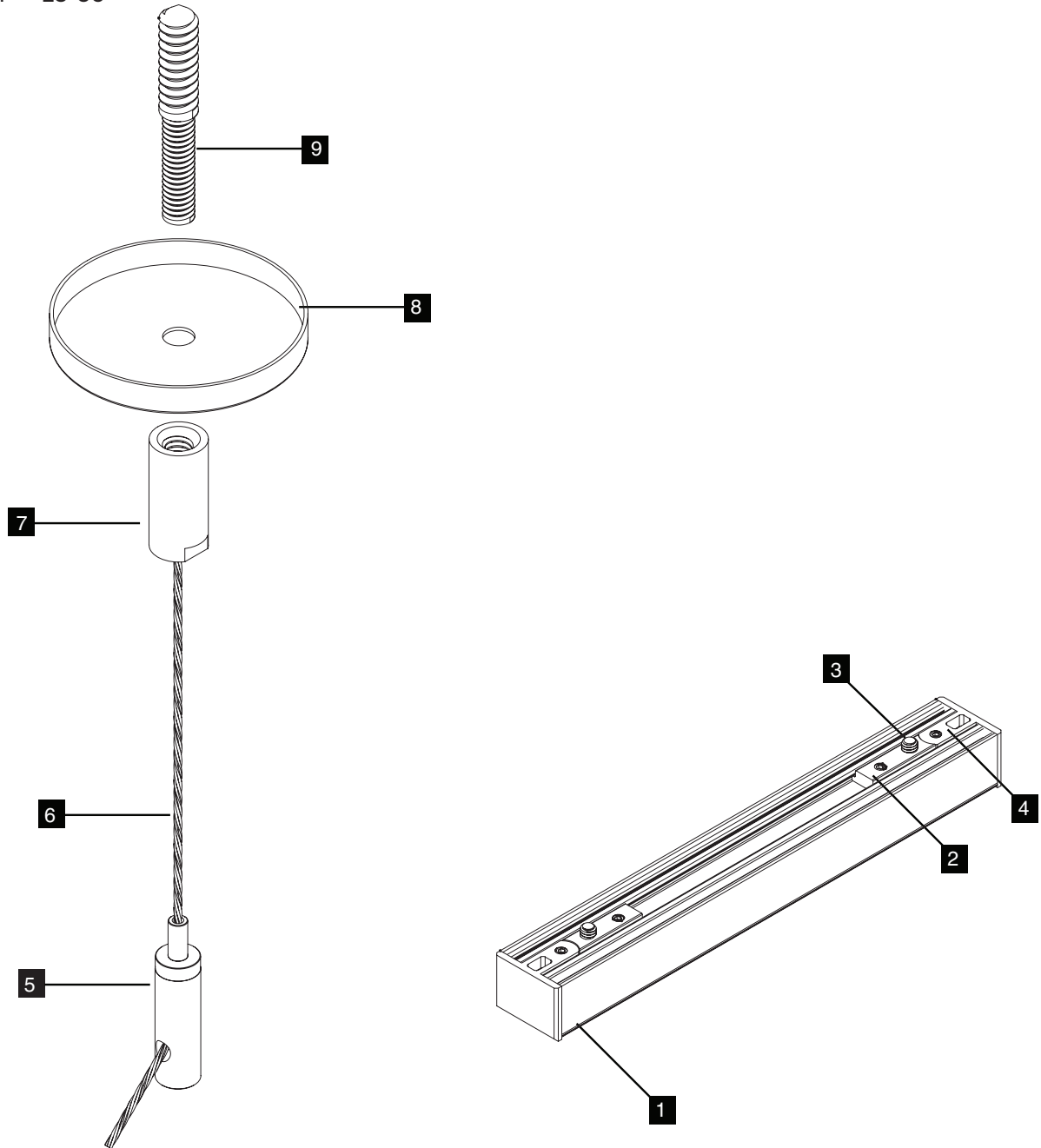

NON-POWERED FEED KIT

| | | | | |
|----------------------|-----------------------------|---------------------|--------------------|------------------------|
| 1 VERS | 2 Suspension Bracket | 3 8-32 Screw | 4 Endcap | 5 Cable Gripper |
| 6 1/16" Cable | 7 Cable Coupler | 8 Canopy | 9 Lag Screw | |