



# VERS-GRAZER (04) FOR WARM DIM APPLICATIONS

## 24VDC Linear Fixtures - Surface & Recessed



Declare

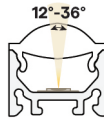

- Optically enhanced VERSatile fixture with narrow grazing properties ranging from 12° to 36°
- The high-quality lens features a proprietary diffusing agent for superior beam control and clean edges
- Durable anodized aluminum housings with integrated metal endcaps
- With an internal White Optics coating, the fixture achieves greater lumen output
- Consult factory for field assembly options
- Can be suitable for exterior use when specified as wet, contact factory for more information
- Optional external louver accessory available in white or black for added glare control

### INFORMATION REQUIRED FOR LIGHTING SCHEDULE

1	2	3	4	5	6
PRODUCT	WATTS/ FT	CCT	RATED	LENS	EXTERNAL LOUVER

### ADDITIONAL INFORMATION REQUIRED TO ORDER

7	8	9	10	11	12	13	14	15
WIRE INPUT/ OUTPUT	CONNECTOR/ WIRE IN	CONNECTOR/ WIRE OUT	WIRE COLOR	WIRE TYPE	MOUNTING	FINISH	LENGTH (IN)	EXACT/ OPTIMAL

Sample Part Number: **VERS-04-WD-6.0-19/30-DRY-GZR-L1-BK-P1-BW-BW-BK-CL2-CC-BK-48"-E**

<div>1</div> <div>PRODUCT</div> <div><div>VERS-04-WD</div><div>LED engine is built with 2 wires suitable for phase dimming control. See following pages for compatible power supplies.</div></div> <div><div>VERS-04-DW</div><div>VERS-04-DW-USA</div><div>Select USA option for BAA and BABA projects. Only DRY, PENC, or WET ratings apply.</div><div>LED engine is built with 3 wires requiring 0-10V, DMX or DALI control. Using DALI, DMX, or non QTL power supplies may double watts/ft. See following pages for compatible</div></div>	<div>2</div> <div>WATTS/FT</div> <div><div>6.0</div><div>6.0W/ft</div></div> <div><div>1.5HE</div><div>1.5W/ft HE</div><div>2.5HE</div><div>2.5W/ft HE</div><div>4.0HE</div><div>4.0W/ft HE</div></div> <div><div>1.5HE</div><div>1.5W/ft HE</div><div>2.5HE</div><div>2.5W/ft HE</div></div> <div><div>1.5HE</div><div>1.5W/ft HE</div><div>2.5HE</div><div>2.5W/ft HE</div></div>	<div>3</div> <div>CCT</div> <div><div>19/27</div><div>1900K/2700K</div><div>19/30</div><div>1900K/3000K</div></div> <div><div>20/27</div><div>2000K/2700K</div><div>20/30</div><div>2000K/3000K</div><div>27/40</div><div>2700K/4000K</div><div>27/55</div><div>2700K/5500K</div></div> <div><div>24/30</div><div>2400K/3000K</div><div>27/40</div><div>2700K/4000K</div></div> <div><div>20/27</div><div>2000K/2700K</div><div>20/30</div><div>2000K/3000K</div><div>27/40</div><div>2700K/4000K</div><div>27/55</div><div>2700K/5500K</div></div>	<div>4</div> <div>RATED</div> <div><div>DRY</div><div>WET</div><div>IP20</div><div>IP67</div></div> <div><div>Can be suitable for exterior use, contact factory for more information</div></div> <div><div>DRY</div><div>IP20</div></div> <div><div>DMP</div><div>PENC</div><div>IP54</div><div>IP67</div></div> <div><div>PENC-partially encapsulated; N/A for TBC clips</div></div> <div><div>WET</div><div>IP67</div></div> <div><div>Can be suitable for exterior use, contact factory for more information</div></div>	<div>5</div> <div>LENS</div> <div><div>25D</div><div>GZR</div><div>Optical 25°</div><div>Grazer</div></div> <div><div>For representation of LED visibility, see Diode Visibility section on following pages. For beam angles, see Photometric Performance section on following pages</div></div>	<div>6</div> <div>EXTERNAL LOUVER</div> <div><div>L1-WH</div><div>L1-BK</div><div>L2-ST</div><div>L2-BK</div><div>L2-WH</div><div>N/A</div><div>White Plastic</div><div>Black Plastic</div><div>Satin Anodized Aluminum</div><div>Black Anodized Aluminum</div><div>White Powder Coated Aluminum</div><div>No Louver</div></div> <div><div>Plastic Louvers come in 12" lengths, multiple pieces will be used to match fixture length. Aluminum louvers come in maximum 98" lengths and will be cut to match fixture length. White and custom painted finishes are not compatible with L2 external louvers.</div></div>
<div>7</div> <div>WIRE INPUT/OUTPUT</div> <div><div>SINGLE (Input only)</div><div>S1</div><div>End Feed</div><div>S2</div><div>Bottom Feed</div><div>S3</div><div>Left Side Feed</div><div>S4</div><div>Right Side Feed</div></div> <div><div>When using TBC Mounting, a bare wire S2 wire feed is recommended. See install instructions for details.</div></div> <div><div>PASS THROUGH (Input/output)</div><div>P1</div><div>End Feed</div><div>P2</div><div>Bottom Feed</div><div>P3</div><div>Left Side Feed</div><div>P4</div><div>Right Side Feed</div></div> <div><div>Pass Through options are not available for PENC rating. When using TBC Mounting, a bare wire P2 wire feed is recommended. See install instructions for details.</div></div>	<div>8</div> <div>CONNECTOR/WIRE IN</div> <div><div>BW</div><div>CON6</div><div>CON24</div><div>Bare Wire (Standard 36")</div><div>Connector 6"</div><div>Connector 24"</div></div> <div><div>BW: Standard length is 36". Max length is 120". Request custom length by writing in part number next to BW (example: BW48)</div></div> <div><div>BW</div><div>CON6</div><div>CON24</div><div>Bare Wire (Standard 36")</div><div>Connector 6"</div><div>Connector 24"</div></div> <div><div>BW: Standard length is 36", Max length is 120". Request custom length by writing in part number next to BW (example: BW48)</div></div>	<div>9</div> <div>CONNECTOR/WIRE OUT</div> <div><div>CLS</div><div>Closed End (No feed)</div></div> <div><div>BW</div><div>CON6</div><div>CON24</div><div>Bare Wire (Standard 36")</div><div>Connector 6"</div><div>Connector 24"</div></div> <div><div>BW: Standard length is 36", Max length is 120". Request custom length by writing in part number next to BW (example: BW48)</div></div>	<div>10</div> <div>WIRE COLOR</div> <div><div>WH</div><div>BK</div><div>White</div><div>Black</div></div>		
<div>11</div> <div>WIRE TYPE</div> <div><div>CL2</div><div>CL2P</div><div>Class 2</div><div>Plenum Rated</div></div> <div><div>CL2P only available with bare wire leads (BW)</div></div>	<div>12</div> <div>MOUNTING</div> <div><div>CC</div><div>MG</div><div>TBC-03</div><div>TBC-04</div><div>TBC-05</div><div>TBC-06</div><div>TBC-07</div><div>TBC-08</div><div>Concealed Clip</div><div>Magnet</div><div>9/16" Flat TB-Grid</div><div>15/16" Flat or Tegular TB-Grid</div><div>9/16" Tegular TB-Grid or 9/16" Flat TB-Grid, with External Louver</div><div>9/16" Tegular TB-Grid, with External Louver</div><div>15/16" Flat TB-Grid, with External Louver</div><div>15/16" Tegular TB-Grid, with External Louver</div></div>	<div>13</div> <div>FINISH</div> <div><div>ST</div><div>BK</div><div>BZ</div><div>WH</div><div>CU</div><div>Satin</div><div>Black</div><div>Bronze</div><div>White</div><div>Custom</div></div> <div><div>White and Custom finishes not compatible with external louvers. Custom finishes require a longer lead time, consult factory.</div></div>	<div>14</div> <div>LENGTH (IN)</div> <div><div>Minimum length is 12", maximum length is 98" not including end caps. Contact us for lengths under 12".</div></div>	<div>15</div> <div>EXACT/OPTIMAL</div> <div><div>O</div><div>E</div><div>Optimal Illumination</div><div>Exact Specified Length</div></div> <div><div>Exact fixtures match the exact length you specify, but they may have dim spots at the ends. Optimal fixtures are slightly shorter than the length specified, but provide full illumination from end to end. See Exact/Optimal Fixture Length charts.</div></div>	

5 year warranty | Warranty only valid with QTL power supplies | Field modifications void warranty | Data subject to change, all data has +/- 5% tolerance



# VERS-GRAZER (04) FOR WARM DIM APPLICATIONS

24VDC Linear Fixtures - Surface & Recessed

## 1 PRODUCT - DIMENSIONS

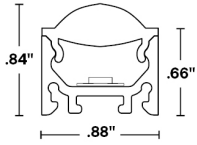

Profile with GZR lens

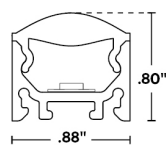

Profile with 25D lens

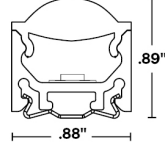

Profile with GZR lens & concealed clip

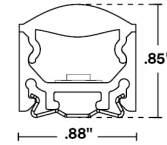

Profile with 25D lens, concealed clip & end cap

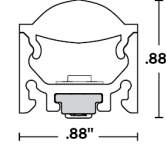

Profile with GZR lens & magnetic clip

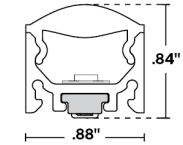

Profile with 25D lens, magnetic clip & end cap

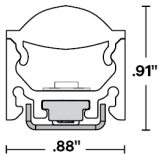

Profile with GZR lens, magnet mount clip & magnetic mount accessory

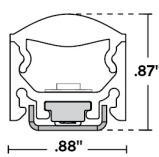

Profile with 25D lens, magnet mount clip, magnetic mount accessory & end cap

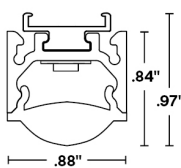

Profile with GRZ lens & TBC-03

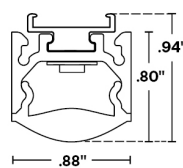

Profile with 25D lens & TBC-03

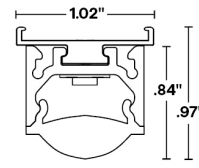

Profile with GRZ lens & TBC-04

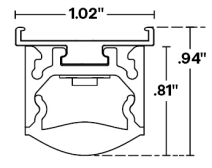

Profile with 25D lens & TBC-04

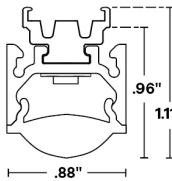

Profile with GRZ lens & TBC-05

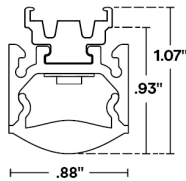

Profile with 25D lens & TBC-05

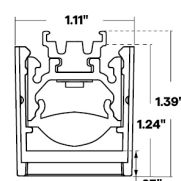

Profile with GRZ lens TBC-05 & L1 Louver

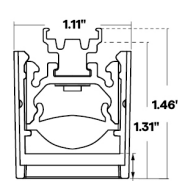

Profile with GRZ lens TBC-06 & L1 Louver

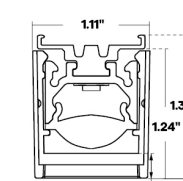

Profile with GRZ lens TBC-07 & L1 Louver

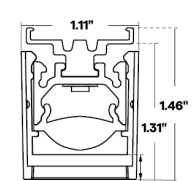

Profile with GRZ lens TBC-08 & L1 Louver

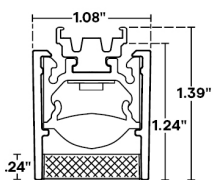

Profile with GRZ lens, TBC-05, & L2 Louver

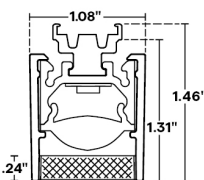

Profile with GRZ lens, TBC-06, & L2 Louver

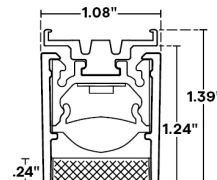

Profile with GZR lens, TBC-07, & L2 Louver

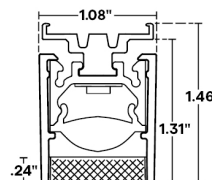

Profile with GRZ lens, TBC-08, & L2 Louver

## 2 DELIVERED LUMENS

[Calculated L70 = 70000 hrs]  
Tested with VERS-04-WD-\*\*-30-DRY

	6.0 W/FT	
	LM/FT	CRI
GZR	502	97
25D	485	97

[Calculated L70 = 70000 hrs]  
Tested with VERS-04-DW-\*\*-30-DRY

	1.5HE W/FT		2.5HE W/FT		4.0HE W/FT	
	LM/FT	CRI	LM/FT	CRI	LM/FT	CRI
GZR	169	98	266	98	411	98
25D	162	98	256	98	385	98



# VERS-GRAZER (04) FOR WARM DIM APPLICATIONS

## 24VDC Linear Fixtures - Surface & Recessed

### 5 DIODE VISIBILITY



Optical lens  
GZR - Grazer lens

### PHOTOMETRIC PERFORMANCE

Nominal beam spread shown, beam spread varies based on light engine. For more detailed information, see photometric data.

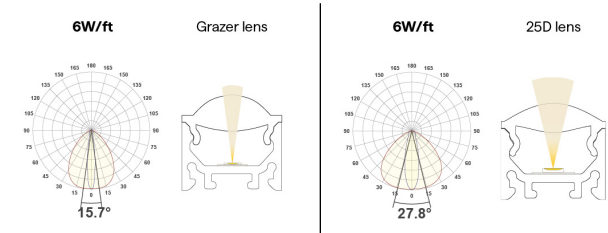

### TEMPERATURE RATINGS

		DW 1.5 HE W/FT						DW 2.5 HE W/FT				DW 4.0 HE W/FT			
		WD 6.0 W/FT		Q-Tran power supply other than DALI, DMX		DALI, DMX, or non-Q-Tran power supply		Q-Tran power supply other than DALI, DMX		DALI, DMX, or non-Q-Tran power supply		Q-Tran power supply other than DALI, DMX		DALI, DMX, or non-Q-Tran power supply	
		Min	Max	Min	Max	Min	Max	Min	Max	Min	Max	Min	Max	Min	Max
DRY	Ambient Operating Temp - Surface	-4°F	115°F	-4°F	145°F	-4°F	135°F	-4°F	135°F	-4°F	120°F	-4°F	125°F	-4°F	110°F
DMP	Ambient Operating Temp - Surface	—	—	-4°F	140°F	-4°F	130°F	-4°F	130°F	-4°F	115°F	—	—	—	—
WET	Ambient Operating Temp - Surface	-4°F	110°F	-4°F	140°F	-4°F	130°F	-4°F	130°F	-4°F	115°F	—	—	—	—
PENC	Ambient Operating Temp - Surface	—	—	-4°F	135°F	-4°F	120°F	-4°F	125°F	-4°F	105°F	—	—	—	—

### 6 EXTERNAL LOUVER

PLASTIC

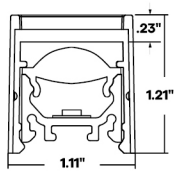
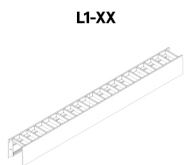
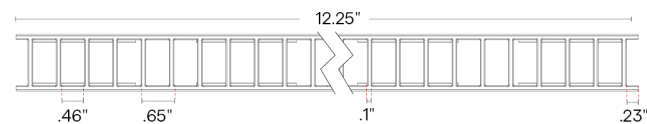

Profile with plastic louver

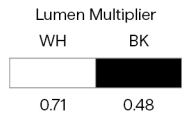

METAL

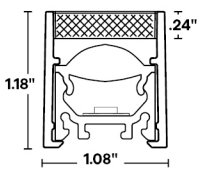
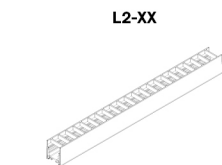
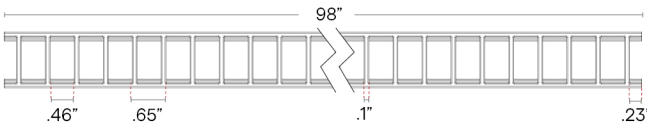

Profile with metal louver

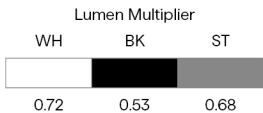



# VERS-GRAZER (04) FOR WARM DIM APPLICATIONS

24VDC Linear Fixtures - Surface & Recessed

## 7 WIRE INPUT/OUTPUT

SINGLE (Input only)

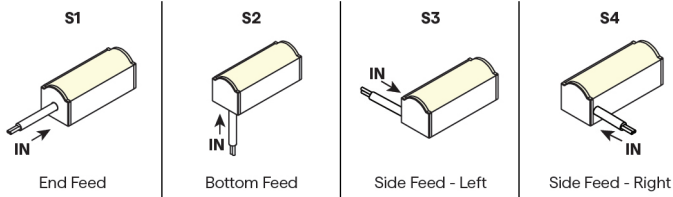

PASS THROUGH (Input/Output)

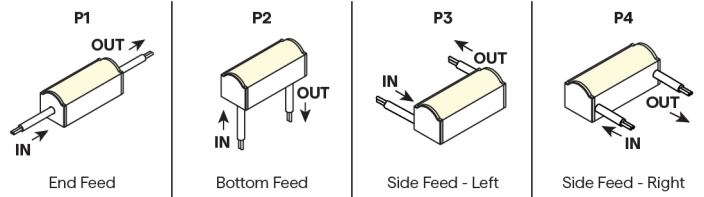

## CONFIGURATION OPTIONS

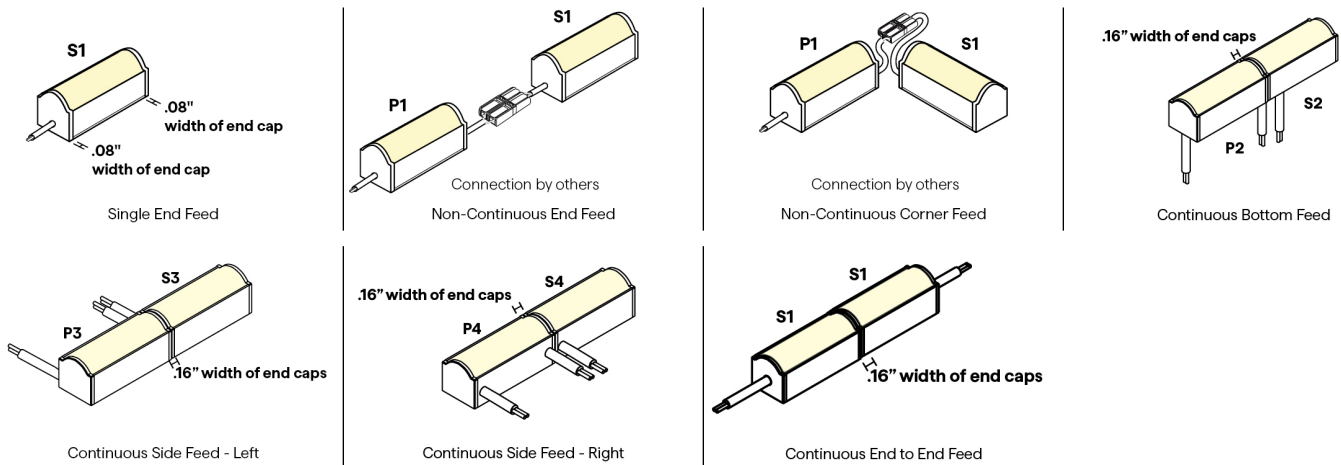

## 8 / 9 CONNECTOR/WIRE - IN/OUT

Connector/Wire In or Out not needed to specify product.

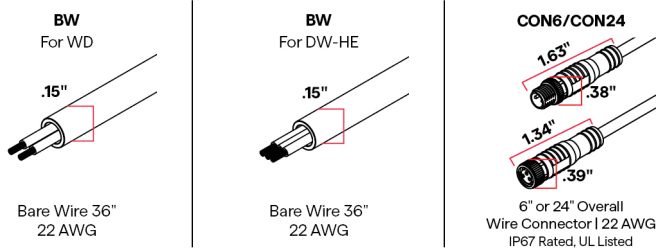

## 10 WIRE COLOR





# VERS-GRAZER (04) FOR WARM DIM APPLICATIONS

## 24VDC Linear Fixtures - Surface & Recessed

### 12 MOUNTING

CC  
(CC-01)



Concealed Clip

2 pieces of hardware provided for 4' or less; 4 pieces of hardware provided for greater than 4'

To order separately use CC-01

Each clips comes with a #4 x 5/8" Flat Head screw.

CC  
(CC-02)

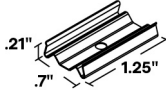

Louver Concealed Clip  
Required if L1 or L2 Louver is selected

2 pieces of hardware provided for 4' or less; 4 pieces of hardware provided for greater than 4'

To order separately use CC-02

Each clips comes with a #4 x 5/8" Flat Head screw.

MG



Magnet Clip

One MG provided per foot

To order separately use MG-02

MMA-02

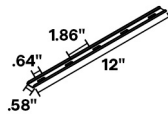

Magnet Mount  
Accessory for MG-02

Sold separately, to order use MMA-02

Each clip comes with a #6 Flat Screw

Required when mounting to a non-magnetic surface

TBC-03

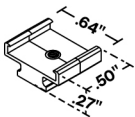

Plastic T-Bar Clip

Use on 9/16" Flat Drop Ceiling; not compatible with PENC

2 clips provided for first 12"; 1 clip provided for each additional 12" or less length

To order separately use TBC-03

Each pair of clips comes with M2.5 x 4mm set screw and Allen key

TBC-04

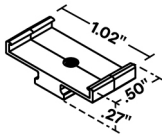

Plastic T-Bar Clip

Use on 15/16" Flat or Tegular Drop Ceiling; not compatible with PENC

2 clips provided for first 12"; 1 clip provided for each additional 12" or less length

To order separately use TBC-04

Each pair of clips comes with M2.5 x 4mm set screw and Allen key

TBC-05

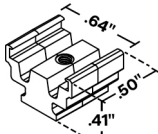

Plastic T-Bar Clip

Use on 9/16" Tegular Drop Ceiling or with Louver on 9/16" Flat Drop Ceiling; not compatible with PENC

2 clips provided for first 12"; 1 clip provided for each additional 12" or less length

To order separately use TBC-05

Each pair of clips comes with M2.5 x 4mm set screw and Allen key

TBC-06

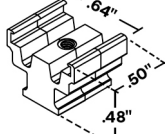

Plastic T-Bar Clip

Use with Louver on 9/16" Tegular Drop Ceiling; not compatible with PENC

2 clips provided for first 12"; 1 clip provided for each additional 12" or less length

To order separately use TBC-06

Each pair of clips comes with M2.5 x 4mm set screw and Allen key

TBC-07

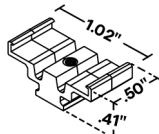

Plastic T-Bar Clip

Use with Louver on 15/16" Flat Drop Ceiling; not compatible with PENC

2 clips provided for first 12"; 1 clip provided for each additional 12" or less length

To order separately use TBC-07

Each pair of clips comes with M2.5 x 4mm set screw and Allen key

TBC-08

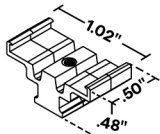

Plastic T-Bar Clip

Use with Louver on 15/16" Tegular Drop Ceiling; not compatible with PENC

2 clips provided for first 12"; 1 clip provided for each additional 12" or less length

To order separately use TBC-08

Each pair of clips comes with M2.5 x 4mm set screw and Allen key

### 13 FINISH

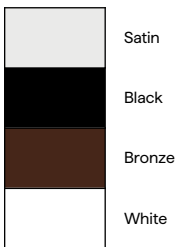

Custom finishes require a longer lead time, consult factory



# VERS-GRAZER (04) FOR WARM DIM APPLICATIONS

24VDC Linear Fixtures - Surface & Recessed

## 15 EXACT/OPTIMAL FIXTURE LENGTH

Exact fixtures are the exact length specified. Optimal fixtures' length is rounded down based on LED cut points to allow the fixture to be illuminated end to end. For runs with multiple fixtures that need to fill a specific length, it's recommended to order all optimal fixtures with an exact fixture at the end of the run.

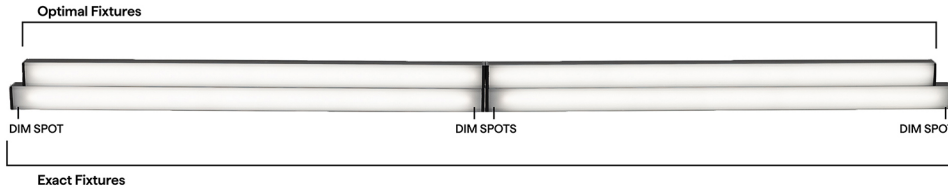

## WD DRY, DMP, PENC LENGTHS BY INCH

Available in any length in between 12" and 98" not including end caps, chart below shows example lengths. Exact fixtures are the length specified. Optimal fixtures' length is rounded down with illumination end to end. All fixtures' tolerance is +0 - 1/8". Consult factory for lengths under 12".

### EXACT LENGTH

Requested Length	Potential dim spot on either end of fixture
12"	1"
13"	0.5"
14"	1"
15"	0.5"
16"	1"
17"	0.5"
18"	1"
19"	0.5"
20"	1"
21"	0.5"
22"	1"
23"	0.5"
24"	1"
36"	1"
48"	1"
60"	1"
72"	1"
84"	1"
96"	1"

### OPTIMAL LENGTH: highlighted rows are closest to requested nominal length

Requested Nominal Length	S1 & S2		P1 & P2		S3 & S4		P3 & P4	
	S1 IN End Feed	S2 IN Bottom Feed	P1 IN End Feed	P2 IN Bottom Feed	S3 IN Side Feed - Left	S4 IN Side Feed - Right	P3 IN Side Feed - Left	P4 IN Side Feed - Right
12"		10.49"		10.74"		10.34"		10.44"
13"		12.49"		12.74"		12.34"		12.44"
14"		12.49"		12.74"		12.34"		12.44"
15"		14.49"		14.74"		14.34"		14.44"
16"		14.49"		14.74"		14.34"		14.44"
17"		16.49"		16.74"		16.34"		16.44"
18"		16.49"		16.74"		16.34"		16.44"
19"		18.49"		18.74"		18.34"		18.44"
20"		18.49"		18.74"		18.34"		18.44"
21"		20.49"		20.74"		20.34"		20.44"
22"		20.49"		20.74"		20.34"		20.44"
23"		22.49"		22.74"		22.34"		22.44"
24"		22.49"		22.74"		22.34"		22.44"
36"		34.49"		34.74"		34.34"		34.44"
48"		46.49"		46.74"		46.34"		46.44"
60"		58.49"		58.74"		58.34"		58.44"
72"		70.49"		70.74"		70.34"		70.44"
84"		82.49"		82.74"		82.34"		82.44"
96"		94.49"		94.74"		94.34"		94.44"



# VERS-GRAZER (04) FOR WARM DIM APPLICATIONS

24VDC Linear Fixtures - Surface & Recessed

## WD WET LENGTHS BY INCH

Available in any length in between 12" and 98" not including end caps, chart below shows example lengths. Exact fixtures are the length specified. Optimal fixtures' length is rounded down with illumination end to end. All fixtures' tolerance is +0 - 1/8". Consult factory for lengths under 12".

### EXACT LENGTH

Requested Length	Potential dim spot on either end of fixture
12"	1"
13"	0.5"
14"	1"
15"	0.5"
16"	1"
17"	0.5"
18"	1"
19"	0.5"
20"	1"
21"	0.5"
22"	1"
23"	0.5"
24"	1"
36"	1"
48"	1"
60"	1"
72"	1"
84"	1"
96"	1"

### OPTIMAL LENGTH: highlighted rows are closest to requested nominal length

Requested Nominal Length	S1 & S2		P1 & P2		S3 & S4		P3 & P4	
	S1 End Feed IN	S2 Bottom Feed IN	P1 End Feed IN	P2 Bottom Feed IN	S3 Side Feed - Left IN	S4 Side Feed - Right IN	P3 Side Feed - Left IN	P4 Side Feed - Right IN
12"								
13"								
14"								
15"								
16"								
17"								
18"								
19"								
20"								
21"								
22"								
23"								
24"								
36"								
48"								
60"								
72"								
84"								
96"								

## DW-HE DRY, DMP, PENC LENGTHS BY INCH

Available in any length in between 12" and 98" not including end caps, chart below shows example lengths. Exact fixtures are the length specified. Optimal fixtures' length is rounded down with illumination end to end. All fixtures' tolerance is +0 - 1/8". Consult factory for lengths under 12".

### EXACT LENGTH

Requested Length	Potential dim spot on either end of fixture
12"	1"
13"	0.5"
14"	1"
15"	0.5"
16"	1"
17"	0.5"
18"	1"
19"	0.5"
20"	1"
21"	0.5"
22"	1"
23"	0.5"
24"	1"
36"	1"
48"	1"
60"	1"
72"	1"
84"	1"
96"	1"

### OPTIMAL LENGTH: highlighted rows are closest to requested nominal length

Requested Nominal Length	S1 & S2		P1 & P2		S3 & S4		P3 & P4	
	S1 End Feed IN	S2 Bottom Feed IN	P1 End Feed IN	P2 Bottom Feed IN	S3 Side Feed - Left IN	S4 Side Feed - Right IN	P3 Side Feed - Left IN	P4 Side Feed - Right IN
12"								
13"								
14"								
15"								
16"								
17"								
18"								
19"								
20"								
21"								
22"								
23"								
24"								
36"								
48"								
60"								
72"								
84"								
96"								





# VERS-GRAZER (04) FOR WARM DIM APPLICATIONS

24VDC Linear Fixtures - Surface & Recessed

## DW-HE WET LENGTHS BY INCH

Available in any length in between 12" and 98" not including end caps, chart below shows example lengths. Exact fixtures are the length specified. Optimal fixtures' length is rounded down with illumination end to end. All fixtures' tolerance is +0 - 1/8". Consult factory for lengths under 12".

### EXACT LENGTH

Requested Length	Potential dim spot on either end of fixture
12"	1"
13"	0.5"
14"	1"
15"	0.5"
16"	1"
17"	0.5"
18"	1"
19"	0.5"
20"	1"
21"	0.5"
22"	1"
23"	0.5"
24"	1"
36"	1"
48"	1"
60"	1"
72"	1"
84"	1"
96"	1"

### OPTIMAL LENGTH: highlighted rows are closest to requested nominal length

Requested Nominal Length	S1 & S2		P1 & P2		S3 & S4		P3 & P4	
	S1 End Feed IN	S2 Bottom Feed IN	P1 End Feed IN	P2 Bottom Feed IN	S3 Side Feed - Left IN	S4 Side Feed - Right IN	P3 Side Feed - Left IN	P4 Side Feed - Right IN
12"	10.74"		11.14"		10.64"		10.84"	
13"	12.74"		11.14"		12.64"		12.84"	
14"	12.74"		13.14"		12.64"		12.84"	
15"	14.74"		13.14"		14.64"		14.84"	
16"	14.74"		15.14"		14.64"		14.84"	
17"	16.74"		15.14"		16.64"		16.84"	
18"	16.74"		17.14"		16.64"		16.84"	
19"	18.74"		17.14"		18.64"		18.84"	
20"	18.74"		19.14"		18.64"		18.84"	
21"	20.74"		19.14"		20.64"		20.84"	
22"	20.74"		21.14"		20.64"		20.84"	
23"	22.74"		21.14"		22.64"		22.84"	
24"	22.74"		23.14"		22.64"		22.84"	
36"	34.74"		35.14"		34.64"		34.84"	
48"	46.74"		47.14"		46.64"		46.84"	
60"	58.74"		59.14"		58.64"		58.84"	
72"	70.74"		71.14"		70.64"		70.84"	
84"	82.74"		83.14"		82.64"		82.84"	
96"	94.74"		95.14"		94.64"		94.84"	

## COMPATIBLE POWER SUPPLIES

See power supplies cut sheets for more information. Data subject to change, all data has +/- 5% tolerance.

DIM TO LEVEL	INDOOR		OUTDOOR	
	DW-HE Warm Dim Applications	WD	DW-HE Warm Dim Applications	WD
0.1%	QT-CAB-eLED+DALI-DT6 QT-CAB-eLED+DALI-DT8 QT-CAB-eLED+DALI-DT8-AWN QT-CAB-eLED+WD QT-CAB-eLED+WD-AWN QTM-eLED+DALI-DT6 QTM-eLED+DALI-DT8 QTM-eLED+DALI-DT8-AWN QTM-eLED+WD QTM-eLED+WD-AWN QZ-DW	QT-CAB-QZ-PH/0-10V QT-CAB-eLED+0-10V QT-CAB-eLED+DALI-DT6 QT-CAB-eLED+DALI-DT6-AWN QTM-eLED+0-10V QTM-eLED+DALI-DT6 QTM-eLED+DALI-DT6-AWN QZ-BOWTIE+DIMMER QZ-DMX QZ-PH/0-10V QZ-STICK-PH/0-10V QZLP	Q-SET-QZ-DW QOM-eLED+DALI-DT6 QOM-eLED+DALI-DT8 QOM-eLED+PS-DALI-DT6 QOM-eLED+PS-DALI-DT8 QOM-eLED+WD QZ-DW	Q-SET-QZ-PH/0-10V Q-SET-eLED+0-10V QOM-eLED+0-10V QOM-eLED+DALI-DT6 QOM-eLED+PS-DALI-DT6 QZ-DMX QZ-PH/0-10V
1%	QZ-DALI-DT8	QTM-eLED(E) QZ-DALI-DT6	Q-SET+QZ-DALI-DT8 QZ-DALI-DT8	Q-SET+QZ-DALI-DT6 QZ-DALI-DT6
10%	Non-Dim Power Supply with WD App Dongle	Non-Dim Power Supply with SW App Dongle		









# VERS-GRAZER (04) FOR WARM DIM APPLICATIONS

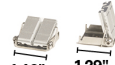

24VDC Linear Fixtures - Surface & Recessed

DIMMING PROTOCOL	INDOOR		OUTDOOR	
	DW-HE Warm Dim Applications	WD	DW-HE Warm Dim Applications	WD
Phase	QZ-DW	QT-CAB-QZ-PH/0-10V QTM-eLED(E) QZ-BOWTIE+DIMMER QZ-PH/0-10V QZ-STICK-PH/0-10V QZLP	Q-SET-QZ-DW QZ-DW	Q-SET-QZ-PH/0-10V QZ-PH/0-10V
0-10V	QT-CAB-eLED+WD QT-CAB-eLED+WD-AWN QTM-eLED+WD QTM-eLED+WD-AWN QZ-DW	QT-CAB-QZ-PH/0-10V QT-CAB-eLED+0-10V QTM-eLED+0-10V QZ-PH/0-10V QZ-STICK-PH/0-10V QZLP	Q-SET-QZ-DW QOM-eLED+WD QZ-DW	Q-SET-QZ-PH/0-10V Q-SET-eLED+0-10V QOM-eLED+0-10V QZ-PH/0-10V
Lutron Athena	QT-CAB-eLED+DALI-DT8-AWN QT-CAB-eLED+WD-AWN QTM-eLED+DALI-DT8-AWN QTM-eLED+WD-AWN	QT-CAB-eLED+DALI-DT6-AWN QTM-eLED+DALI-DT6-AWN		
ECO System		QTM-eLED(E)		
DMX If using DW LED, wattage must be doubled		QZ-DMX		QZ-DMX
DALI-2: DT6 If using DW LED, wattage must be doubled except for AWN	QT-CAB-eLED+DALI-DT6 QTM-eLED+DALI-DT6	QT-CAB-eLED+DALI-DT6 QT-CAB-eLED+DALI-DT6-AWN QTM-eLED+DALI-DT6 QTM-eLED+DALI-DT6-AWN QZ-DALI-DT6	QOM-eLED+DALI-DT6	Q-SET+QZ-DALI-DT6 QOM-eLED+DALI-DT6 QZ-DALI-DT6
DALI-2: DT8 If using DW LED, wattage must be doubled except for AWN	QT-CAB-eLED+DALI-DT8 QT-CAB-eLED+DALI-DT8-AWN QTM-eLED+DALI-DT8 QTM-eLED+DALI-DT8-AWN QZ-DALI-DT8		Q-SET+QZ-DALI-DT8 QOM-eLED+DALI-DT8 QZ-DALI-DT8	
SCENE App Dimmed	Non-Dim Power Supply with WD App Dongle	Non-Dim Power Supply with SW App Dongle		

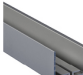
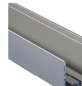
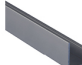
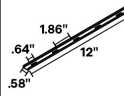
## COMPATIBLE MOUNTING ACCESSORIES

<b>HINGE - HMB-M</b>  1.41" .71" Adjustable mounting bracket - Medium	<b>HINGE - HMB-L</b>  1.46" 1.29" Adjustable mounting bracket - Large	<b>HINGE - HMB-XL</b>  4" 1.46" Adjustable mounting bracket - XLarge	<b>Q-PIVOT</b>  .75" 1.03" Small mounting accessory	<b>Q-ANGLE</b>  2.23" 1.38" Adjustable mounting accessory	<b>NU-GRAZER</b>  U Mounting Bracket	<b>NJ-GRAZER</b>  J Mounting Bracket	<b>BL-GRAZER</b>  Backwards L Mounting Bracket	<b>MMA-02</b>  1.86" 12" .64" .58" Magnet Mount Accessory for MG-02
--	--	---	--	--	---	--	---	--

## COMPATIBLE WIRING ACCESSORIES

<b>Q-mini-J</b>  2" 1.25" UL Listed, miniature junction box, DRY/DMP (WET rated with silicone)	<b>Q-mini-J5</b>  2.80" 2.27" UL Listed, miniature junction box, DRY/DMP (WET rated with silicone)
---	---



# VERS-GRAZER (04) FOR WARM DIM APPLICATIONS

24VDC Linear Fixtures - Surface & Recessed

## COMPATIBLE CONTROL ACCESSORIES

### SCENE APP DONGLE



Wi-Fi or Bluetooth  
Connectivity

## COMPATIBLE APPS

### NFC APP



Read and write  
DMX addresses and  
adjust voltage