





# VERS-GRAZER (04) STATIC COLOR

24VDC Linear Fixtures - Surface & Recessed

## 1 PRODUCT - DIMENSIONS

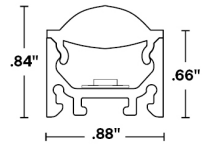

Profile with GZR lens

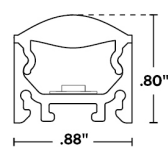

Profile with 25D lens

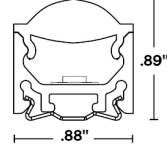

Profile with GZR lens & concealed clip

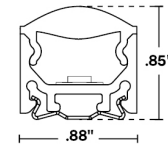

Profile with 25D lens, concealed clip & end cap

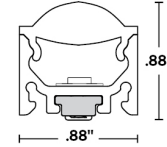

Profile with GZR lens & magnetic clip

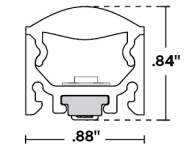

Profile with 25D lens, magnetic clip & end cap

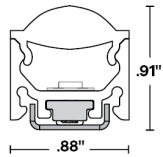

Profile with GZR lens, magnet mount clip & magnetic mount accessory

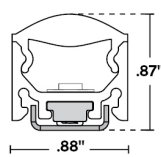

Profile with 25D lens, magnet mount clip, magnetic mount accessory & end cap

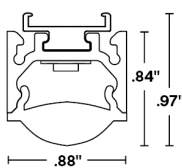

Profile with GRZ lens & TBC-03

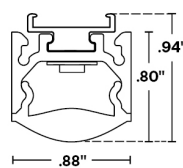

Profile with 25D lens & TBC-03

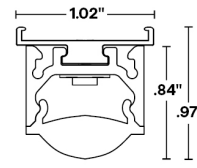

Profile with GRZ lens & TBC-04

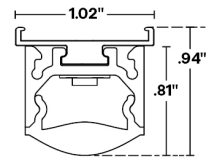

Profile with 25D lens & TBC-04

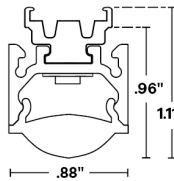

Profile with GRZ lens & TBC-05

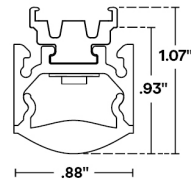

Profile with 25D lens & TBC-05

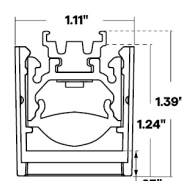

Profile with GRZ lens TBC-05 & L1 Louver

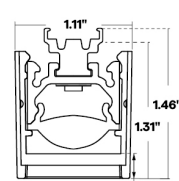

Profile with GRZ lens TBC-06 & L1 Louver

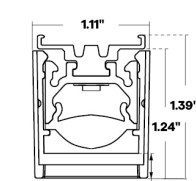

Profile with GRZ lens TBC-07 & L1 Louver

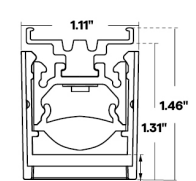

Profile with GRZ lens TBC-08 & L1 Louver

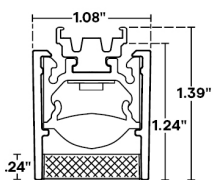

Profile with GRZ lens, TBC-05, & L2 Louver

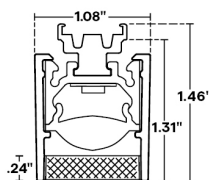

Profile with GRZ lens, TBC-06, & L2 Louver

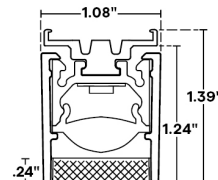

Profile with GRZ lens, TBC-07, & L2 Louver

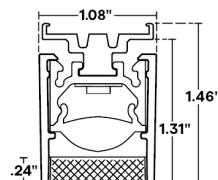

Profile with GRZ lens, TBC-08, & L2 Louver

## 2 DELIVERED LUMENS

[Calculated L70 = 50000 hrs]

Tested with VERS-04-SC-5.0-\*\*-DRY

|     | Red   |            | Green |            | Blue  |            | Amber |            |
|-----|-------|------------|-------|------------|-------|------------|-------|------------|
|     | LM/FT | Wavelength | LM/FT | Wavelength | LM/FT | Wavelength | LM/FT | Wavelength |
| GZR | 124   | 635        | 589   | 521        | 137   | 467        | 95    | 595        |
| 25D | 111   | 634        | 545   | 520        | 118   | 466        | 84    | 596        |



# VERS-GRAZER (04) STATIC COLOR

24VDC Linear Fixtures - Surface & Recessed

## 5 DIODE VISIBILITY

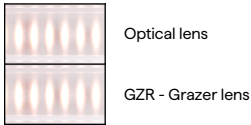

## PHOTOMETRIC PERFORMANCE

Nominal beam spread shown, beam spread varies based on light engine. For more detailed information, see photometric data.

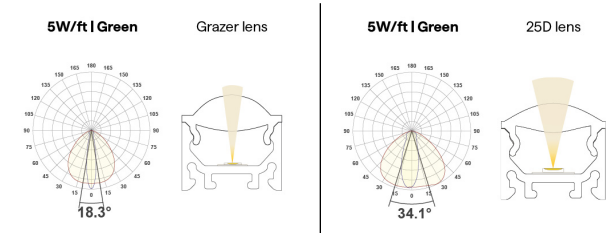

## TEMPERATURE RATINGS

|      |                                  | 5.0 W/FT |       |
|------|----------------------------------|----------|-------|
|      |                                  | Min      | Max   |
| DRY  | Ambient Operating Temp - Surface | -4°F     | 125°F |
| DMP  | Ambient Operating Temp - Surface | -4°F     | 120°F |
| WET  | Ambient Operating Temp - Surface | -4°F     | 120°F |
| PENC | Ambient Operating Temp - Surface | -4°F     | 105°F |

## 6 EXTERNAL LOUVER

PLASTIC

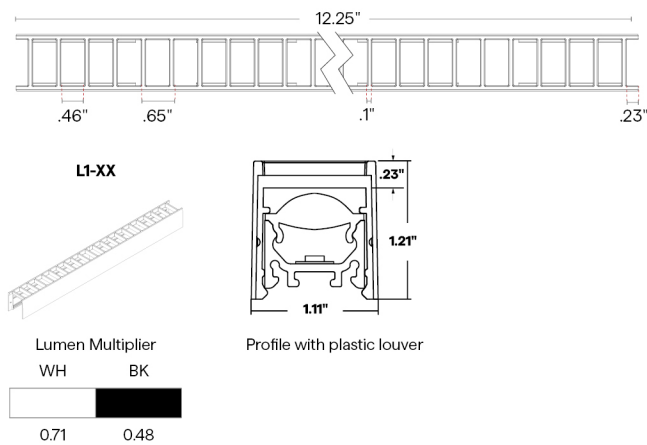

METAL

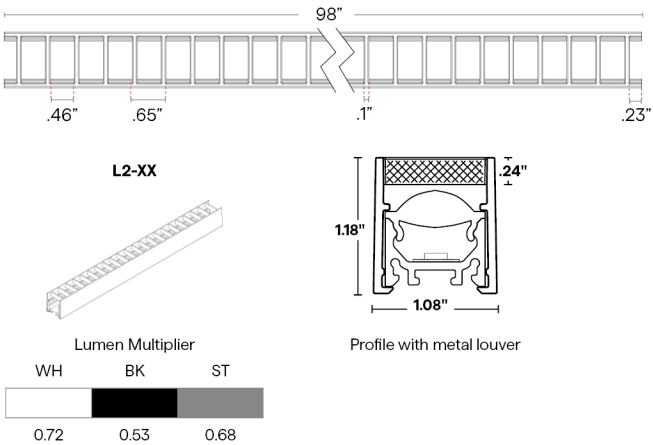



# VERS-GRAZER (04) STATIC COLOR

24VDC Linear Fixtures - Surface & Recessed

## 7 WIRE INPUT/OUTPUT

SINGLE (Input only)

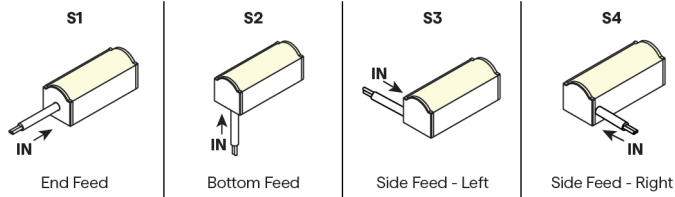

PASS THROUGH (Input/Output)

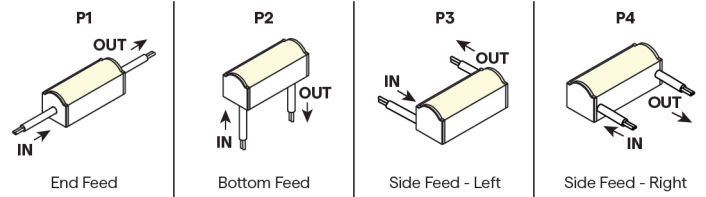

## CONFIGURATION OPTIONS

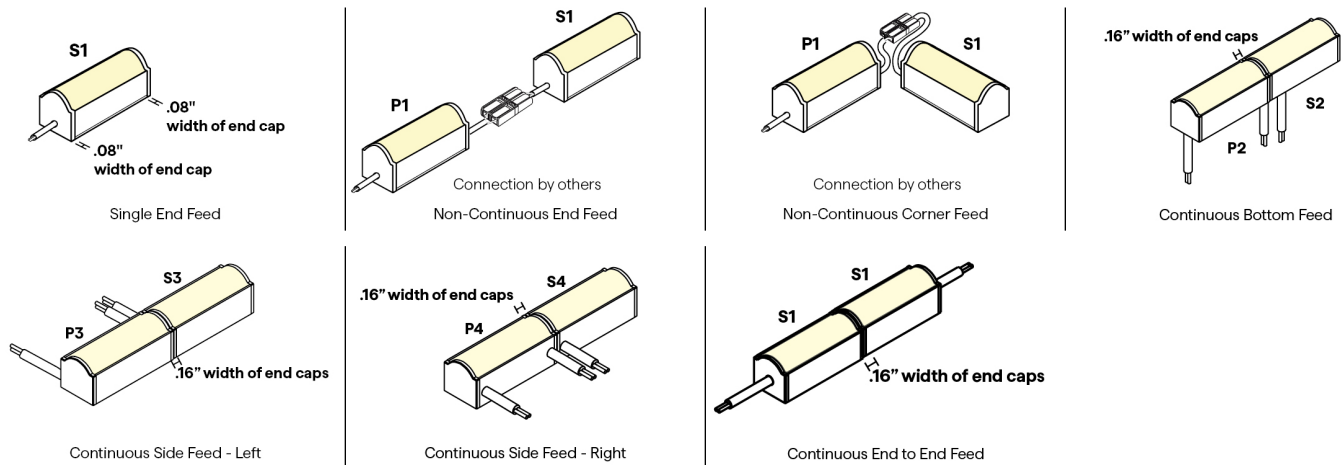

## 8 / 9 CONNECTOR/WIRE - IN/OUT

Connector/Wire In or Out not needed to specify product.

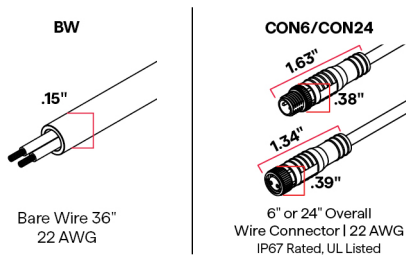

## 10 WIRE COLOR

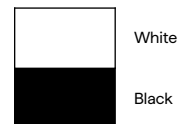



# VERS-GRAZER (04) STATIC COLOR

24VDC Linear Fixtures - Surface & Recessed

## 12 MOUNTING

**CC**  
(CC-01)

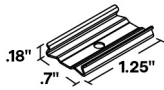

Concealed Clip

2 pieces of hardware provided for 4' or less; 4 pieces of hardware provided for greater than 4'

To order separately use CC-01

Each clips comes with a #4 x 5/8" Flat Head screw.

**CC**  
(CC-02)

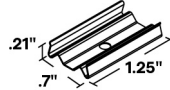

Louver Concealed Clip  
Required if L1 or L2 Louver is selected

2 pieces of hardware provided for 4' or less; 4 pieces of hardware provided for greater than 4'

To order separately use CC-02

Each clips comes with a #4 x 5/8" Flat Head screw.

**MG**

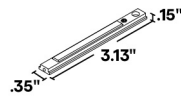

Magnet Clip

One MG provided per foot

To order separately use MG-02

**MMA-02**

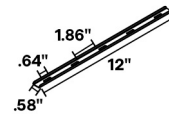

Magnet Mount  
Accessory for MG-02

Sold separately, to order use MMA-02

Each clip comes with a #6 Flat Screw

Required when mounting to a non-magnetic surface

**TBC-03**

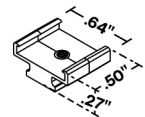

Plastic T-Bar Clip

Use on 9/16" Flat Drop Ceiling; not compatible with PENC

2 clips provided for first 12"; 1 clip provided for each additional 12" or less length

To order separately use TBC-03

Each pair of clips comes with M2.5 x 4mm set screw and Allen key

**TBC-04**

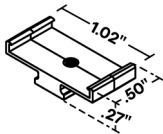

Plastic T-Bar Clip

Use on 15/16" Flat or Tegular Drop Ceiling; not compatible with PENC

2 clips provided for first 12"; 1 clip provided for each additional 12" or less length

To order separately use TBC-04

Each pair of clips comes with M2.5 x 4mm set screw and Allen key

**TBC-05**

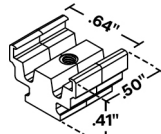

Plastic T-Bar Clip

Use on 9/16" Tegular Drop Ceiling or with Louver on 9/16" Flat Drop Ceiling; not compatible with PENC

2 clips provided for first 12"; 1 clip provided for each additional 12" or less length

To order separately use TBC-05

Each pair of clips comes with M2.5 x 4mm set screw and Allen key

**TBC-06**

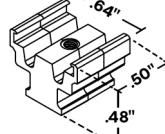

Plastic T-Bar Clip

Use with Louver on 9/16" Tegular Drop Ceiling; not compatible with PENC

2 clips provided for first 12"; 1 clip provided for each additional 12" or less length

To order separately use TBC-06

Each pair of clips comes with M2.5 x 4mm set screw and Allen key

**TBC-07**

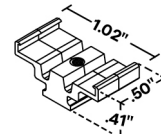

Plastic T-Bar Clip

Use with Louver on 15/16" Flat Drop Ceiling; not compatible with PENC

2 clips provided for first 12"; 1 clip provided for each additional 12" or less length

To order separately use TBC-07

Each pair of clips comes with M2.5 x 4mm set screw and Allen key

**TBC-08**

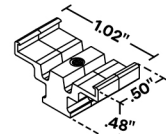

Plastic T-Bar Clip

Use with Louver on 15/16" Tegular Drop Ceiling; not compatible with PENC

2 clips provided for first 12"; 1 clip provided for each additional 12" or less length

To order separately use TBC-08

Each pair of clips comes with M2.5 x 4mm set screw and Allen key

## 13 FINISH



Custom color available



# VERS-GRAZER (04) STATIC COLOR

24VDC Linear Fixtures - Surface & Recessed

## 15 EXACT/OPTIMAL FIXTURE LENGTH

Exact fixtures are the exact length specified. Optimal fixtures' length is rounded down based on LED cut points to allow the fixture to be illuminated end to end. For runs with multiple fixtures that need to fill a specific length, it's recommended to order all optimal fixtures with an exact fixture at the end of the run.

Optimal Fixtures

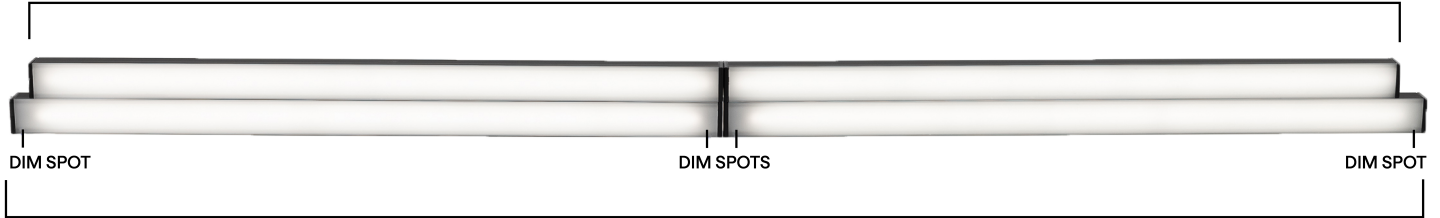

Exact Fixtures

## SC DRY, DMP, PENC LENGTHS BY INCH

Available in any length in between 12" and 98" not including end caps, chart below shows example lengths. Exact fixtures are the length specified. Optimal fixtures' length is rounded down with illumination end to end. All fixtures' tolerance is +0 - 1/8". Consult factory for lengths under 12".

EXACT LENGTH

| Requested Length | Potential dim spot on either end of fixture |
|------------------|---|
| 12"              | 1"  |
| 13"              | 0.5"  |
| 14"              | 1"  |
| 15"              | 0.5"  |
| 16"              | 1"  |
| 17"              | 0.5"  |
| 18"              | 1"  |
| 19"              | 0.5"  |
| 20"              | 1"  |
| 21"              | 0.5"  |
| 22"              | 1"  |
| 23"              | 0.5"  |
| 24"              | 1"  |
| 36"              | 1"  |
| 48"              | 1"  |
| 60"              | 1"  |
| 72"              | 1"  |
| 84"              | 1"  |
| 96"              | 1"  |

OPTIMAL LENGTH: highlighted rows are closest to requested nominal length

| Requested Nominal Length | S1 & S2              |                         | P1 & P2              |                         | S3 & S4                      |                               | P3 & P4                      |                               |
|--------------------------|----------------------|-------------------------|----------------------|-------------------------|------------------------------|-------------------------------|------------------------------|-------------------------------|
|                          | S1<br>End Feed<br>IN | S2<br>Bottom Feed<br>IN | P1<br>End Feed<br>IN | P2<br>Bottom Feed<br>IN | S3<br>Side Feed - Left<br>IN | S4<br>Side Feed - Right<br>IN | P3<br>Side Feed - Left<br>IN | P4<br>Side Feed - Right<br>IN |
| 12"                      | 10.49"               |                         | 10.74"               |                         | 10.34"                       |                               | 10.44"                       |                               |
| 13"                      | 12.49"               |                         | 12.74"               |                         | 12.34"                       |                               | 12.44"                       |                               |
| 14"                      | 12.49"               |                         | 12.74"               |                         | 12.34"                       |                               | 12.44"                       |                               |
| 15"                      | 14.49"               |                         | 14.74"               |                         | 14.34"                       |                               | 14.44"                       |                               |
| 16"                      | 14.49"               |                         | 14.74"               |                         | 14.34"                       |                               | 14.44"                       |                               |
| 17"                      | 16.49"               |                         | 16.74"               |                         | 16.34"                       |                               | 16.44"                       |                               |
| 18"                      | 16.49"               |                         | 16.74"               |                         | 16.34"                       |                               | 16.44"                       |                               |
| 19"                      | 18.49"               |                         | 18.74"               |                         | 18.34"                       |                               | 18.44"                       |                               |
| 20"                      | 18.49"               |                         | 18.74"               |                         | 18.34"                       |                               | 18.44"                       |                               |
| 21"                      | 20.49"               |                         | 20.74"               |                         | 20.34"                       |                               | 20.44"                       |                               |
| 22"                      | 20.49"               |                         | 20.74"               |                         | 20.34"                       |                               | 20.44"                       |                               |
| 23"                      | 22.49"               |                         | 22.74"               |                         | 22.34"                       |                               | 22.44"                       |                               |
| 24"                      | 22.49"               |                         | 22.74"               |                         | 22.34"                       |                               | 22.44"                       |                               |
| 36"                      | 34.49"               |                         | 34.74"               |                         | 34.34"                       |                               | 34.44"                       |                               |
| 48"                      | 46.49"               |                         | 46.74"               |                         | 46.34"                       |                               | 46.44"                       |                               |
| 60"                      | 58.49"               |                         | 58.74"               |                         | 58.34"                       |                               | 58.44"                       |                               |
| 72"                      | 70.49"               |                         | 70.74"               |                         | 70.34"                       |                               | 70.44"                       |                               |
| 84"                      | 82.49"               |                         | 82.74"               |                         | 82.34"                       |                               | 82.44"                       |                               |
| 96"                      | 94.49"               |                         | 94.74"               |                         | 94.34"                       |                               | 94.44"                       |                               |



# VERS-GRAZER (04) STATIC COLOR

24VDC Linear Fixtures - Surface & Recessed

## SC WET LENGTHS BY INCH

Available in any length in between 12" and 98" not including end caps, chart below shows example lengths. Exact fixtures are the length specified. Optimal fixtures' length is rounded down with illumination end to end. All fixtures' tolerance is +0 - 1/8". Consult factory for lengths under 12".

### EXACT LENGTH

| Requested Length | Potential dim spot on either end of fixture |
|------------------|---|
| 12"              | 1"  |
| 13"              | 0.5"  |
| 14"              | 1"  |
| 15"              | 0.5"  |
| 16"              | 1"  |
| 17"              | 0.5"  |
| 18"              | 1"  |
| 19"              | 0.5"  |
| 20"              | 1"  |
| 21"              | 0.5"  |
| 22"              | 1"  |
| 23"              | 0.5"  |
| 24"              | 1"  |
| 36"              | 1"  |
| 48"              | 1"  |
| 60"              | 1"  |
| 72"              | 1"  |
| 84"              | 1"  |
| 96"              | 1"  |

### OPTIMAL LENGTH: highlighted rows are closest to requested nominal length

| Requested Nominal Length | S1 & S2              |                         | P1 & P2              |                         | S3 & S4                      |                               | P3 & P4                      |                               |
|--------------------------|----------------------|-------------------------|----------------------|-------------------------|------------------------------|-------------------------------|------------------------------|-------------------------------|
|                          | S1<br>End Feed<br>IN | S2<br>Bottom Feed<br>IN | P1<br>End Feed<br>IN | P2<br>Bottom Feed<br>IN | S3<br>Side Feed - Left<br>IN | S4<br>Side Feed - Right<br>IN | P3<br>Side Feed - Left<br>IN | P4<br>Side Feed - Right<br>IN |
| 12"                      |                      |                         |                      |                         |                              |                               |                              |                               |
| 13"                      |                      |                         |                      |                         |                              |                               |                              |                               |
| 14"                      |                      |                         |                      |                         |                              |                               |                              |                               |
| 15"                      |                      |                         |                      |                         |                              |                               |                              |                               |
| 16"                      |                      |                         |                      |                         |                              |                               |                              |                               |
| 17"                      |                      |                         |                      |                         |                              |                               |                              |                               |
| 18"                      |                      |                         |                      |                         |                              |                               |                              |                               |
| 19"                      |                      |                         |                      |                         |                              |                               |                              |                               |
| 20"                      |                      |                         |                      |                         |                              |                               |                              |                               |
| 21"                      |                      |                         |                      |                         |                              |                               |                              |                               |
| 22"                      |                      |                         |                      |                         |                              |                               |                              |                               |
| 23"                      |                      |                         |                      |                         |                              |                               |                              |                               |
| 24"                      |                      |                         |                      |                         |                              |                               |                              |                               |
| 36"                      |                      |                         |                      |                         |                              |                               |                              |                               |
| 48"                      |                      |                         |                      |                         |                              |                               |                              |                               |
| 60"                      |                      |                         |                      |                         |                              |                               |                              |                               |
| 72"                      |                      |                         |                      |                         |                              |                               |                              |                               |
| 84"                      |                      |                         |                      |                         |                              |                               |                              |                               |
| 96"                      |                      |                         |                      |                         |                              |                               |                              |                               |

## COMPATIBLE POWER SUPPLIES

See power supplies cut sheets for more information. Data subject to change, all data has +/- 5% tolerance.

| DIM TO LEVEL | INDOOR   | OUTDOOR   |
|--------------|--|---|
|              | SC   | SC  |
| Dim to Black | Q6M-DC+CAP<br>QTM-DC+CAP<br>iQ-PH<br>iQ-PH+QD1   | QOM-DC+CAP<br>QOM-PH  |
| 0.1%         | QT-CAB-QZ-PH/0-10V<br>QT-CAB-eLED+0-10V<br>QT-CAB-eLED+0-10V-AWN<br>QT-CAB-eLED+DALI-DT6<br>QT-CAB-eLED+DALI-DT6-AWN<br>QTM-eLED+0-10V<br>QTM-eLED+0-10V-AWN<br>QTM-eLED+DALI-DT6<br>QTM-eLED+DALI-DT6-AWN<br>QZ-BOWTIE+DIMMER<br>QZ-DMX<br>QZ-PH/0-10V<br>QZ-STICK-PH/0-10V<br>QZLP | Q-SET-QZ-DMX<br>Q-SET-QZ-PH/0-10V<br>Q-SET-eLED+0-10V<br>QOM-eLED+0-10V<br>QOM-eLED+DALI-DT6<br>QOM-eLED+PS-DALI-DT6<br>QZ-DMX<br>QZ-PH/0-10V |
| 1%           | QTM-eLED(E)<br>QZ-DALI-DT6   | Q-SET+QZ-DALI-DT6   |
| 10%          | Non-Dim Power Supply with SW App Dongle  |   |



# VERS-GRAZER (04) STATIC COLOR

## 24VDC Linear Fixtures - Surface & Recessed

| DIMMING PROTOCOL | INDOOR   | OUTDOOR  |
|------------------|--|--|
|                  | SC   | SC   |
| Non-Dim          | QT-CAB-eLED-ND<br>QTM-eLED-ND<br>QZ-ND   | Q-SET-QZ-ND<br>Q-SET-eLED-ND<br>QOM-eLED-ND<br>QZ-ND<br>iQ-ND-50-65    |
| Phase            | Q6M-DC+CAP<br>QT-CAB-QZ-PH/0-10V<br>QTM-DC+CAP<br>QTM-eLED(E)<br>QZ-BOWTIE+DIMMER<br>QZ-PH/0-10V<br>QZ-STICK-PH/0-10V<br>QZLP<br>iQ-PH<br>iQ-PH+QD1  | Q-SET-QZ-PH/0-10V<br>QOM-DC+CAP<br>QOM-PH<br>QZ-PH/0-10V               |
| 0-10V            | QT-CAB-QZ-PH/0-10V<br>QT-CAB-eLED+0-10V<br>QT-CAB-eLED+0-10V-AWN<br>QTM-eLED+0-10V<br>QTM-eLED+0-10V-AWN<br>QZ-PH/0-10V<br>QZ-STICK-PH/0-10V<br>QZLP | Q-SET-QZ-PH/0-10V<br>Q-SET-eLED+0-10V<br>QOM-eLED+0-10V<br>QZ-PH/0-10V |
| Lutron Athena    | QT-CAB-eLED+0-10V-AWN<br>QT-CAB-eLED+DALI-DT6-AWN<br>QTM-eLED+0-10V-AWN<br>QTM-eLED+DALI-DT6-AWN   |  |
| ECO System       | QTM-eLED(E)  |  |
| DMX              | QZ-DMX   | Q-SET-QZ-DMX<br>QZ-DMX   |
| DALI-2: DT6      | QT-CAB-eLED+DALI-DT6<br>QT-CAB-eLED+DALI-DT6-AWN<br>QTM-eLED+DALI-DT6<br>QTM-eLED+DALI-DT6-AWN<br>QZ-DALI-DT6  | Q-SET+QZ-DALI-DT6<br>QOM-eLED+DALI-DT6                                 |
| SCENE App Dimmed | Non-Dim Power Supply with SW App Dongle  |  |

### COMPATIBLE MOUNTING ACCESSORIES

HINGE - HMB-M

Adjustable mounting bracket - Medium

HINGE - HMB-L

Adjustable mounting bracket - Large

HINGE - HMB-XL

Adjustable mounting bracket - XLarge

Q-PIVOT

Small mounting accessory

Q-ANGLE

Adjustable mounting accessory

NU-GRAZER

U Mounting Bracket

NJ-GRAZER

J Mounting Bracket

BL-GRAZER

Backwards L Mounting Bracket

### COMPATIBLE WIRING ACCESSORIES

Q-mini-J

UL Listed, miniature junction box, DRY/DMP (WET rated with silicone)

Q-mini-J5

UL Listed, miniature junction box, DRY/DMP (WET rated with silicone)

CON120-EXT

10ft Con cable extender DRY/DMP/WET

CON FOUR-FER

Splits lead from one to four LED Con connectors DRY/DMP/WET

CON M - BARREL F

Male con to barrel cable adaptor DRY/DMP





## VERS-GRAZER (04) STATIC COLOR

24VDC Linear Fixtures - Surface & Recessed

---

### COMPATIBLE APPS

#### NFC APP



Read and write  
DMX addresses and  
adjust voltage