

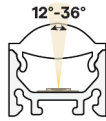

VERS-GRAZER (04) STATIC WHITE

24VDC Linear Fixtures - Surface & Recessed



- Optically enhanced VERSatile fixture with narrow grazing properties ranging from 12° to 36°
- The high-quality lens features a proprietary diffusing agent for superior beam control and clean edges
- Features integrated metal endcaps
- Mounting options include a concealed or magnetic clip
- With an internal White Optics coating, the fixture achieves greater lumen output
- Durable anodized aluminum housings
- Consult factory for field assembly options
- Can be suitable for exterior use when specified as wet, contact factory for more information
- Optional external louver accessory available in white or black for added glare control

INFORMATION REQUIRED FOR LIGHTING SCHEDULE

1	2	3	4	5	6
PRODUCT	WATTS/FT	CCT	RATED	LENS	EXTERNAL LOUVER

ADDITIONAL INFORMATION REQUIRED TO ORDER

7	8	9	10	11	12	13	14	15
WIRE INPUT/OUTPUT	CONNECTOR/WIRE IN	CONNECTOR/WIRE OUT	WIRE COLOR	WIRE TYPE	MOUNTING	FINISH	LENGTH (IN)	EXACT/OPTIMAL

Sample Part Number: **VERS-04-SW-5.0-30-DRY-GZR-L1-BK-P1-BW-BW-BK-CL2-CC-BK-48"-E**

<div>1</div> <div>PRODUCT</div> <div><div>VERS-04-SW</div><div>VERS-04-SW-USA</div><div>Select USA option for BAA and BABA projects. Only DRY, PENC, or WET ratings apply.</div><div>See following pages for compatible power supplies.</div></div>	<div>2</div> <div>WATTS/FT</div> <div><div><div>1.5</div><div>1.5W/ft</div></div><div><div>3.0</div><div>3.0W/ft</div></div><div><div>4.0</div><div>4.0W/ft</div></div><div><div>5.0</div><div>5.0W/ft</div></div><div><div>1.5HE</div><div>1.5W/ft HE</div></div><div><div>3.0HE</div><div>3.0W/ft HE</div></div><div><div>6.0HE</div><div>6.0W/ft HE</div></div><div><div>9.0HE</div><div>9.0W/ft HE</div></div></div> <div><div><div>1.5</div><div>1.5W/ft</div></div><div><div>3.0</div><div>3.0W/ft</div></div><div><div>4.0</div><div>4.0W/ft</div></div><div><div>5.0</div><div>5.0W/ft</div></div><div><div>1.5HE</div><div>1.5W/ft HE</div></div><div><div>3.0HE</div><div>3.0W/ft HE</div></div><div><div>6.0HE</div><div>6.0W/ft HE</div></div></div> <div><div><div>1.5</div><div>1.5W/ft</div></div><div><div>3.0</div><div>3.0W/ft</div></div><div><div>4.0</div><div>4.0W/ft</div></div><div><div>5.0</div><div>5.0W/ft</div></div></div>	<div>3</div> <div>CCT</div> <div><div><div>20</div><div>2000K</div></div><div><div>22</div><div>2200K</div></div><div><div>24</div><div>2400K</div></div><div><div>27</div><div>2700K</div></div><div><div>30</div><div>3000K</div></div><div><div>35</div><div>3500K</div></div><div><div>40</div><div>4000K</div></div></div> <div><div><div>24</div><div>2400K</div></div><div><div>27</div><div>2700K</div></div><div><div>30</div><div>3000K</div></div><div><div>35</div><div>3500K</div></div><div><div>40</div><div>4000K</div></div></div> <div><div><div>20</div><div>2000K</div></div><div><div>22</div><div>2200K</div></div><div><div>24</div><div>2400K</div></div><div><div>27</div><div>2700K</div></div><div><div>30</div><div>3000K</div></div><div><div>35</div><div>3500K</div></div><div><div>40</div><div>4000K</div></div></div>	<div>4</div> <div>RATED</div> <div><div><div>DRY</div><div>IP20</div></div><div><div>DMP</div><div>IP54</div></div><div><div>PENC</div><div>IP67</div></div><div><div>PENC-partially encapsulated; N/A for TBC clips</div></div><div><div>WET</div><div>IP67</div></div><div><div>Can be suitable for exterior use, contact factory for more information</div></div></div>	<div>5</div> <div>LENS</div> <div><div><div>25D</div><div>Optical 25°</div></div><div><div>GZR</div><div>Grazer</div></div><div><div>For representation of LED visibility, see Diode Visibility section on following pages. For beam angles, see Photometric Performance section on following pages</div></div></div>	<div>6</div> <div>EXTERNAL LOUVER</div> <div><div><div>L1-WH</div><div>White Plastic</div></div><div><div>L1-BK</div><div>Black Plastic</div></div><div><div>L2-ST</div><div>Satin Anodized Aluminum</div></div><div><div>L2-BK</div><div>Black Anodized Aluminum</div></div><div><div>L2-WH</div><div>White Powder Coated Aluminum</div></div><div><div>N/A</div><div>No Louver</div></div><div><div>Plastic Louvers come in 12" lengths, multiple pieces will be used to match fixture length. Aluminum louvers come in maximum 98" lengths and will be cut to match fixture length. White and custom painted finishes are not compatible with L2 external louvers.</div></div></div>
<div>7</div> <div>WIRE INPUT/OUTPUT</div> <div><div><div>SINGLE (Input only)</div><div><div>S1</div><div>End Feed</div></div><div><div>S2</div><div>Bottom Feed</div></div><div><div>S3</div><div>Left Side Feed</div></div><div><div>S4</div><div>Right Side Feed</div></div><div><div>When using TBC Mounting, a bare wire S2 wire feed is recommended. See install instructions for details.</div></div></div><div><div><div>PASS THROUGH (Input/output)</div><div><div>P1</div><div>End Feed</div></div><div><div>P2</div><div>Bottom Feed</div></div><div><div>P3</div><div>Left Side Feed</div></div><div><div>P4</div><div>Right Side Feed</div></div><div><div>Pass Through options are not available for PENC rating</div></div><div><div>When using TBC Mounting, a bare wire P2 wire feed is recommended. See install instructions for details.</div></div></div></div></div>	<div>8</div> <div>CONNECTOR/WIRE IN</div> <div><div><div>BW</div><div>Bare Wire (Standard 36")</div></div><div><div>CON6</div><div>Connector 6"</div></div><div><div>CON24</div><div>Connector 24"</div></div><div><div>BW: Standard length is 36", Max length is 120". Request custom length by writing in part number next to BW (example: BW48)</div></div><div><div>BW</div><div>Bare Wire (Standard 36")</div></div><div><div>CON6</div><div>Connector 6"</div></div><div><div>CON24</div><div>Connector 24"</div></div><div><div>BW: Standard length is 36", Max length is 120". Request custom length by writing in part number next to BW (example: BW48)</div></div></div>	<div>9</div> <div>CONNECTOR/WIRE OUT</div> <div><div><div>CLS</div><div>Closed End (No feed)</div></div><div><div>BW</div><div>Bare Wire (Standard 36")</div></div><div><div>CON6</div><div>Connector 6"</div></div><div><div>CON24</div><div>Connector 24"</div></div><div><div>BW: Standard length is 36", Max length is 120". Request custom length by writing in part number next to BW (example: BW48)</div></div></div>	<div>10</div> <div>WIRE COLOR</div> <div><div><div>WH</div><div>White</div></div><div><div>BK</div><div>Black</div></div></div>		
<div>11</div> <div>WIRE TYPE</div> <div><div><div>CL2</div><div>Class 2</div></div><div><div>CL2P</div><div>Plenum Rated</div></div><div><div>CL2P only available with bare wire leads (BW)</div></div></div>	<div>12</div> <div>MOUNTING</div> <div><div><div>CC</div><div>Concealed Clip</div></div><div><div>MG</div><div>Magnet</div></div><div><div>TBC-03</div><div>9/16" Flat TB-Grid</div></div><div><div>TBC-04</div><div>15/16" Flat or Tegular TB-Grid</div></div><div><div>TBC-05</div><div>9/16" Tegular TB-Grid or 9/16" Flat TB-Grid, with External Louver</div></div><div><div>TBC-06</div><div>9/16" Tegular TB-Grid, with External Louver</div></div><div><div>TBC-07</div><div>15/16" Flat TB-Grid, with External Louver</div></div><div><div>TBC-08</div><div>15/16" Tegular TB-Grid, with External Louver</div></div></div>	<div>13</div> <div>FINISH</div> <div><div><div>ST</div><div>Satin</div></div><div><div>BK</div><div>Black</div></div><div><div>BZ</div><div>Bronze</div></div><div><div>WH</div><div>White</div></div><div><div>CU</div><div>Custom</div></div><div><div>White and custom painted finishes are not compatible with external louvers. Custom finishes require a longer lead time, consult factory.</div></div></div>	<div>14</div> <div>LENGTH (IN)</div> <div><div><div>Minimum length is 12", maximum length is 98" not including end caps. Contact us for lengths under 12".</div></div></div>	<div>15</div> <div>EXACT/OPTIMAL</div> <div><div><div>O</div><div>Optimal Illumination</div></div><div><div>E</div><div>Exact Specified Length</div></div><div><div>Exact fixtures match the exact length you specify, but they may have dim spots at the ends. Optimal fixtures are slightly shorter than the length specified, but provide full illumination from end to end. See Exact/Optimal Fixture Length charts.</div></div></div>	

5 year warranty | Warranty only valid with QTL power supplies | Field modifications void warranty | Data subject to change, all data has +/- 5% tolerance | Suitable for installation in the storage area of a clothes closet when using wattage of 4.0W/ft or less



VERS-GRAZER (04) STATIC WHITE

24VDC Linear Fixtures - Surface & Recessed

1 PRODUCT - DIMENSIONS

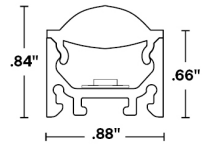

Profile with GZR lens

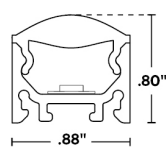

Profile with 25D lens

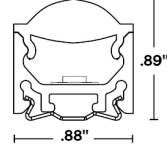

Profile with GZR lens & concealed clip

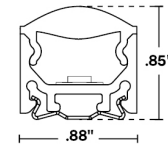

Profile with 25D lens, concealed clip & end cap

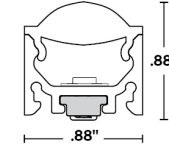

Profile with GZR lens & magnetic clip

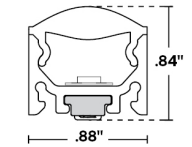

Profile with 25D lens, magnetic clip & end cap

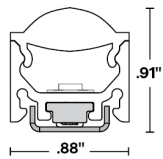

Profile with GZR lens, magnet mount clip & magnetic mount accessory

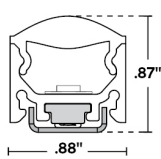

Profile with 25D lens, magnet mount clip, magnetic mount accessory & end cap

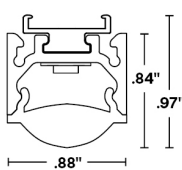

Profile with GZR lens & TBC-03

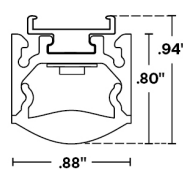

Profile with 25D lens & TBC-03

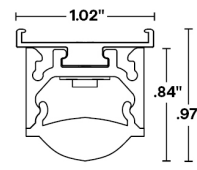

Profile with GZR lens & TBC-04

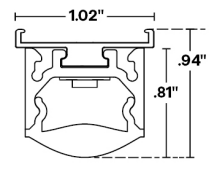

Profile with 25D lens & TBC-04

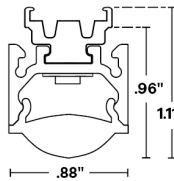

Profile with GZR lens & TBC-05

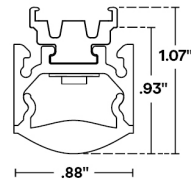

Profile with 25D lens & TBC-05

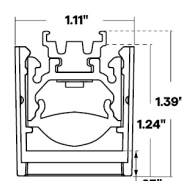

Profile with GZR lens TBC-05 & L1 Louver

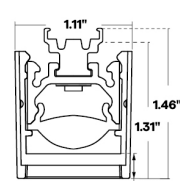

Profile with GZR lens TBC-06 & L1 Louver

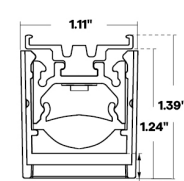

Profile with GZR lens TBC-07 & L1 Louver

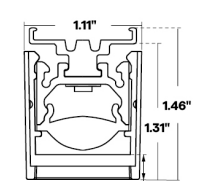

Profile with GZR lens TBC-08 & L1 Louver

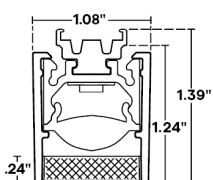

Profile with GZR lens, TBC-05, & L2 Louver

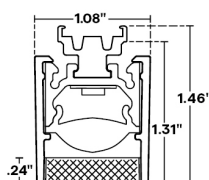

Profile with GZR lens, TBC-06, & L2 Louver

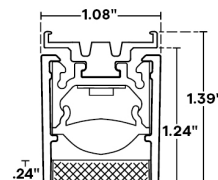

Profile with GZR lens, TBC-07, & L2 Louver

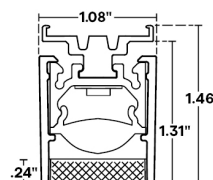

Profile with GZR lens, TBC-08, & L2 Louver

2 DELIVERED LUMENS

[Calculated L70 = 70000 hrs, L70 = 66000 hrs for HE]
Tested with VERS-04-SW-**-30-DRY

	1.5 W/FT		1.5HE W/FT		3.0 W/FT		3.0HE W/FT		4.0 W/FT		5.0 W/FT		6.0HE W/FT		9.0HE W/FT	
	LM/FT	CRI	LM/FT	CRI	LM/FT	CRI	LM/FT	CRI	LM/FT	CRI	LM/FT	CRI	LM/FT	CRI	LM/FT	CRI
GZR	169	98	216	98	294	98	404	97	372	98	449	98	751	98	1108	98
25D	162	98	184	98	281	98	359	97	344	98	422	98	704	98	994	98



VERS-GRAZER (04) STATIC WHITE

24VDC Linear Fixtures - Surface & Recessed

5 DIODE VISIBILITY

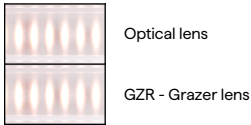

PHOTOMETRIC PERFORMANCE

Nominal beam spread shown, beam spread varies based on light engine. For more detailed information, see photometric data.

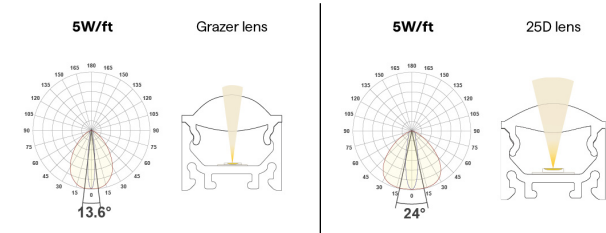

TEMPERATURE RATINGS

		1.5 W/FT		1.5 HE W/FT		3.0 W/FT		3.0 HE W/FT		4.0 W/FT		5.0 W/FT		6.0 HE W/FT		9.0 HE W/FT	
		Min	Max	Min	Max	Min	Max	Min	Max	Min	Max	Min	Max	Min	Max	Min	Max
DRY	Ambient Operating Temp - Surface	-4°F	140°F	-4°F	145°F	-4°F	130°F	-4°F	135°F	-4°F	125°F	-4°F	120°F	-4°F	120°F	-4°F	100°F
DMP	Ambient Operating Temp - Surface	-4°F	135°F	-4°F	140°F	-4°F	125°F	-4°F	130°F	-4°F	120°F	-4°F	115°F	-4°F	115°F	-13°F	95°F
WET	Ambient Operating Temp - Surface	-4°F	135°F	—	—	-4°F	125°F	—	—	-4°F	120°F	-4°F	115°F	—	—	—	—
PENC	Ambient Operating Temp - Surface	-4°F	130°F	-4°F	135°F	-4°F	120°F	-4°F	125°F	-4°F	110°F	-4°F	100°F	-4°F	100°F	—	—

6 EXTERNAL LOUVER

PLASTIC

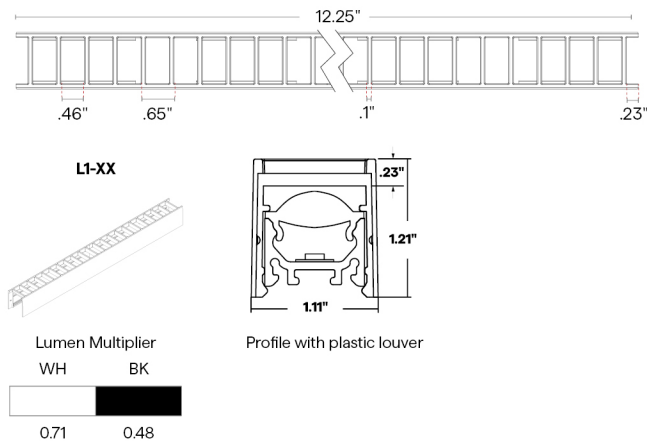

METAL

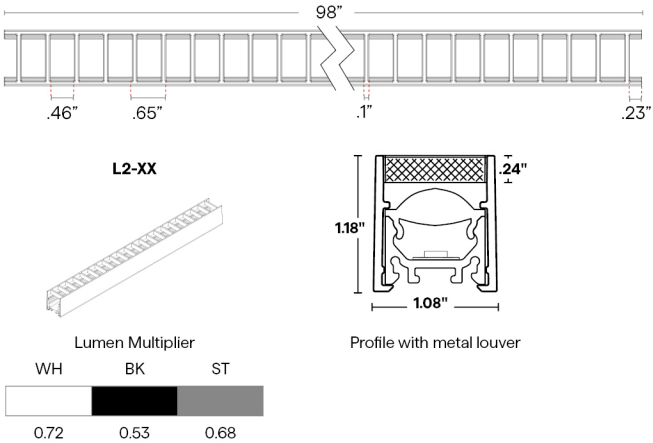



VERS-GRAZER (04) STATIC WHITE

24VDC Linear Fixtures - Surface & Recessed

7 WIRE INPUT/OUTPUT

SINGLE (Input only)

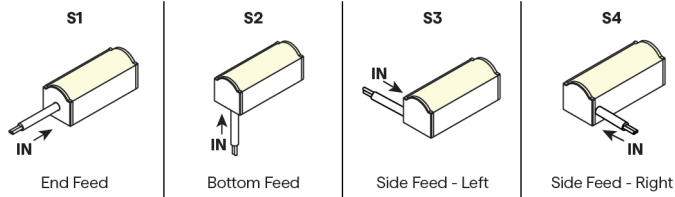

PASS THROUGH (Input/Output)

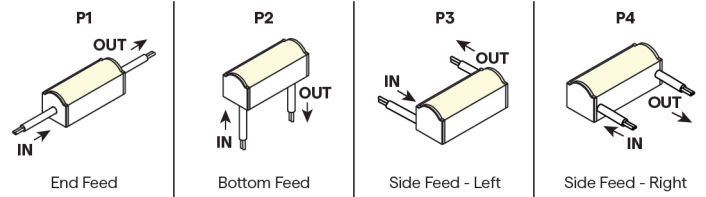

CONFIGURATION OPTIONS

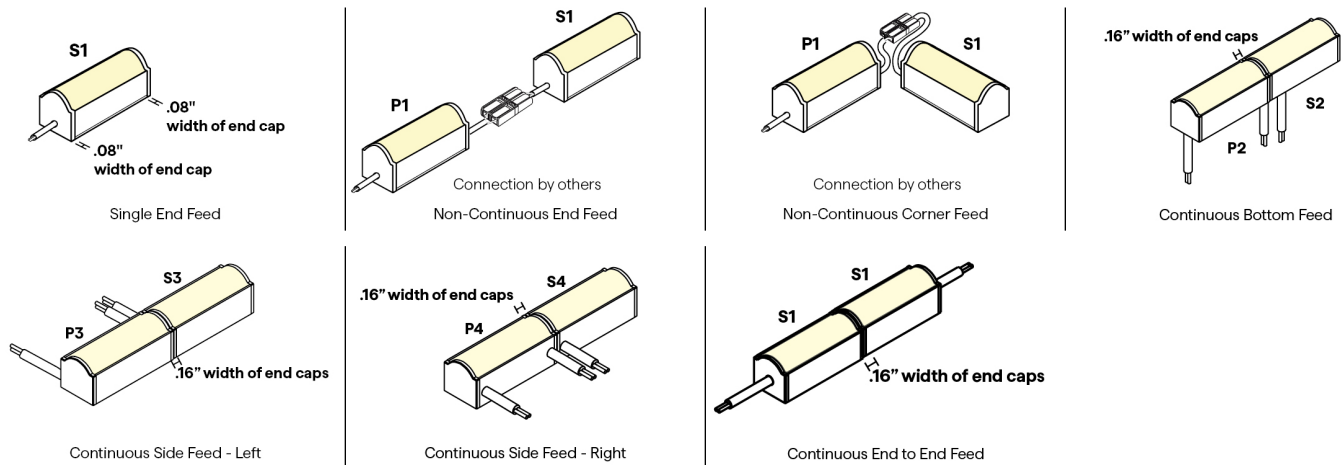

8 / 9 CONNECTOR/WIRE - IN/OUT

Connector/Wire In or Out not needed to specify product.

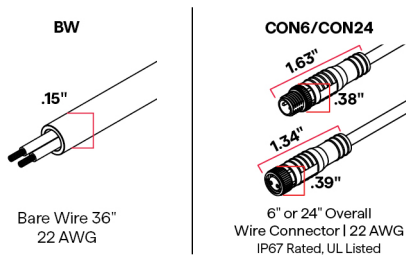

10 WIRE COLOR

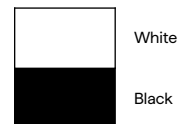



VERS-GRAZER (04) STATIC WHITE

24VDC Linear Fixtures - Surface & Recessed

12 MOUNTING

CC
(CC-01)



Concealed Clip

2 pieces of hardware provided for 4' or less; 4 pieces of hardware provided for greater than 4'

To order separately use CC-01

Each clips comes with a #4 x 5/8" Flat Head screw.

CC
(CC-02)

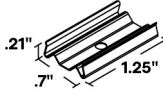

Louver Concealed Clip
Required if L1 or L2 Louver is selected

2 pieces of hardware provided for 4' or less; 4 pieces of hardware provided for greater than 4'

To order separately use CC-02

Each clips comes with a #4 x 5/8" Flat Head screw.

MG



Magnet Clip

One MG provided per foot
To order separately use MG-02

MMA-02

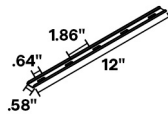

Magnet Mount
Accessory for MG-02

Sold separately, to order use MMA-02

Each clip comes with a #6 Flat Screw

Required when mounting to a non-magnetic surface

TBC-03

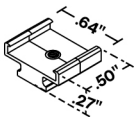

Plastic T-Bar Clip

Use on 9/16" Flat Drop Ceiling; not compatible with PENC

2 clips provided for first 12"; 1 clip provided for each additional 12" or less length

To order separately use TBC-03

Each pair of clips comes with M2.5 x 4mm set screw and Allen key

TBC-04

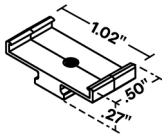

Plastic T-Bar Clip

Use on 15/16" Flat or Tegular Drop Ceiling; not compatible with PENC

2 clips provided for first 12"; 1 clip provided for each additional 12" or less length

To order separately use TBC-04

Each pair of clips comes with M2.5 x 4mm set screw and Allen key

TBC-05

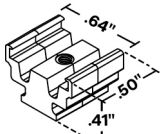

Plastic T-Bar Clip

Use on 9/16" Tegular Drop Ceiling or with Louver on 9/16" Flat Drop Ceiling; not compatible with PENC

2 clips provided for first 12"; 1 clip provided for each additional 12" or less length

To order separately use TBC-05

Each pair of clips comes with M2.5 x 4mm set screw and Allen key

TBC-06

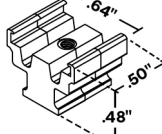

Plastic T-Bar Clip

Use with Louver on 9/16" Tegular Drop Ceiling; not compatible with PENC

2 clips provided for first 12"; 1 clip provided for each additional 12" or less length

To order separately use TBC-06

Each pair of clips comes with M2.5 x 4mm set screw and Allen key

TBC-07

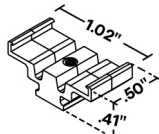

Plastic T-Bar Clip

Use with Louver on 15/16" Flat Drop Ceiling; not compatible with PENC

2 clips provided for first 12"; 1 clip provided for each additional 12" or less length

To order separately use TBC-07

Each pair of clips comes with M2.5 x 4mm set screw and Allen key

TBC-08

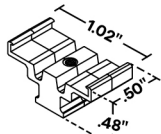

Plastic T-Bar Clip

Use with Louver on 15/16" Tegular Drop Ceiling; not compatible with PENC

2 clips provided for first 12"; 1 clip provided for each additional 12" or less length

To order separately use TBC-08

Each pair of clips comes with M2.5 x 4mm set screw and Allen key

13 FINISH

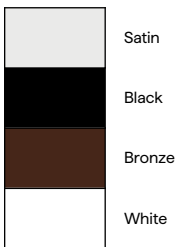

Custom finishes require a longer lead time, consult factory



VERS-GRAZER (04) STATIC WHITE

24VDC Linear Fixtures - Surface & Recessed

15 EXACT/OPTIMAL FIXTURE LENGTH

Exact fixtures are the exact length specified. Optimal fixtures' length is rounded down based on LED cut points to allow the fixture to be illuminated end to end. For runs with multiple fixtures that need to fill a specific length, it's recommended to order all optimal fixtures with an exact fixture at the end of the run.

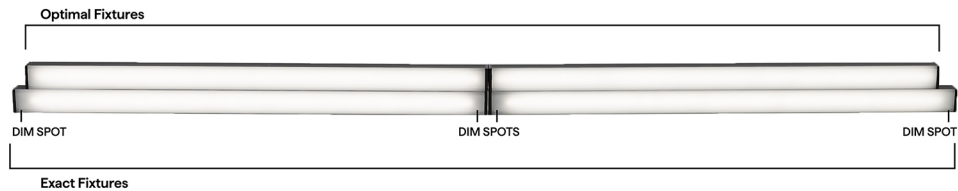

SW DRY, DMP, PENC LENGTHS BY INCH

Available in any length in between 12" and 98" not including end caps, chart below shows example lengths. Exact fixtures are the length specified. Optimal fixtures' length is rounded down with illumination end to end. All fixtures' tolerance is +0 - 1/8". Consult factory for lengths under 12".

EXACT LENGTH

Requested Length	Potential dim spot on either end of fixture
12"	.5"
13"	.5"
14"	.5"
15"	.5"
16"	.5"
17"	.5"
18"	.5"
19"	.5"
20"	.5"
21"	.5"
22"	.5"
23"	.5"
24"	.5"
36"	.5"
48"	.5"
60"	.5"
72"	.5"
84"	.5"
96"	.5"

OPTIMAL LENGTH

Requested Nominal Length	S1 & S2		P1 & P2		S3 & S4		P3 & P4	
	S1	S2	P1	P2	S3	S4	P3	P4
12"	11.49"		11.74"		11.34"		11.44"	
13"	12.49"		12.74"		12.34"		12.44"	
14"	13.49"		13.74"		13.34"		13.44"	
15"	14.49"		14.74"		14.34"		14.44"	
16"	15.49"		15.74"		15.34"		15.44"	
17"	16.49"		16.74"		16.34"		16.44"	
18"	17.49"		17.74"		17.34"		17.44"	
19"	18.49"		18.74"		18.34"		18.44"	
20"	19.49"		19.74"		19.34"		19.44"	
21"	20.49"		20.74"		20.34"		20.44"	
22"	21.49"		21.74"		21.34"		21.44"	
23"	22.49"		22.74"		22.34"		22.44"	
24"	23.49"		23.74"		23.34"		23.44"	
36"	35.49"		35.74"		35.34"		35.44"	
48"	47.49"		47.74"		47.34"		47.44"	
60"	59.49"		59.74"		59.34"		59.44"	
72"	71.49"		71.74"		71.34"		71.44"	
84"	83.49"		83.74"		83.34"		83.44"	
96"	95.49"		95.74"		95.34"		95.44"	



VERS-GRAZER (04) STATIC WHITE

24VDC Linear Fixtures - Surface & Recessed

SW WET LENGTHS BY INCH

Available in any length in between 12" and 98" not including end caps, chart below shows example lengths. Exact fixtures are the length specified. Optimal fixtures' length is rounded down with illumination end to end. All fixtures' tolerance is +0 - 1/8". Consult factory for lengths under 12".

EXACT LENGTH

Requested Length	Potential dim spot on either end of fixture
12"	.5"
13"	.5"
14"	.5"
15"	.5"
16"	.5"
17"	.5"
18"	.5"
19"	.5"
20"	.5"
21"	.5"
22"	.5"
23"	.5"
24"	.5"
36"	.5"
48"	.5"
60"	.5"
72"	.5"
84"	.5"
96"	.5"

OPTIMAL LENGTH

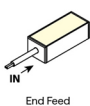
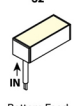
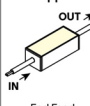
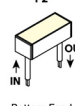
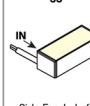
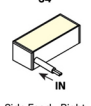
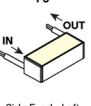
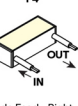
Requested Nominal Length	S1 & S2  End Feed  Bottom Feed	P1 & P2  End Feed  Bottom Feed	S3 & S4  Side Feed - Left  Side Feed - Right	P3 & P4  Side Feed - Left  Side Feed - Right
12"	11.64"	11.79"	11.54"	11.64"
13"	12.64"	12.79"	12.54"	12.64"
14"	13.64"	13.79"	13.54"	13.64"
15"	14.64"	14.79"	14.54"	14.64"
16"	15.64"	15.79"	15.54"	15.64"
17"	16.64"	16.79"	16.54"	16.64"
18"	17.64"	17.79"	17.54"	17.64"
19"	18.64"	18.79"	18.54"	18.64"
20"	19.64"	19.79"	19.54"	19.64"
21"	20.64"	20.79"	20.54"	20.64"
22"	21.64"	21.79"	21.54"	21.64"
23"	22.64"	22.79"	22.54"	22.64"
24"	23.64"	23.79"	23.54"	23.64"
36"	35.64"	35.79"	35.54"	35.64"
48"	47.64"	47.79"	47.54"	47.64"
60"	59.64"	59.79"	59.54"	59.64"
72"	71.64"	71.79"	71.54"	71.64"
84"	83.64"	83.79"	83.54"	83.64"
96"	95.64"	95.79"	95.54"	95.64"

SW-HE DRY, DMP, PENC LENGTHS BY INCH

Available in any length in between 12" and 98" not including end caps, chart below shows example lengths. Exact fixtures are the length specified. Optimal fixtures' length is rounded down with illumination end to end. All fixtures' tolerance is +0 - 1/8". Consult factory for lengths under 12".

EXACT LENGTH

Requested Length	Potential dim spot on either end of fixture
12"	1"
13"	0.5"
14"	1"
15"	0.5"
16"	1"
17"	0.5"
18"	1"
19"	0.5"
20"	1"
21"	0.5"
22"	1"
23"	0.5"
24"	1"
36"	1"
48"	1"
60"	1"
72"	1"
84"	1"
96"	1"

OPTIMAL LENGTH: highlighted rows are closest to requested nominal length

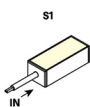
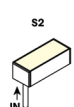
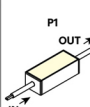
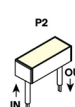
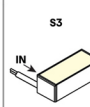
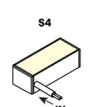
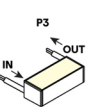
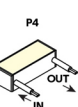
Requested Nominal Length	S1 & S2  End Feed  Bottom Feed	P1 & P2  End Feed  Bottom Feed	S3 & S4  Side Feed - Left  Side Feed - Right	P3 & P4  Side Feed - Left  Side Feed - Right
12"	10.49"	10.74"	10.34"	10.44"
13"	12.49"	12.74"	12.34"	12.44"
14"	12.49"	12.74"	12.34"	12.44"
15"	14.49"	14.74"	14.34"	14.44"
16"	14.49"	14.74"	14.34"	14.44"
17"	16.49"	16.74"	16.34"	16.44"
18"	16.49"	16.74"	16.34"	16.44"
19"	18.49"	18.74"	18.34"	18.44"
20"	18.49"	18.74"	18.34"	18.44"
21"	20.49"	20.74"	20.34"	20.44"
22"	20.49"	20.74"	20.34"	20.44"
23"	22.49"	22.74"	22.34"	22.44"
24"	22.49"	22.74"	22.34"	22.44"
36"	34.49"	34.74"	34.34"	34.44"
48"	46.49"	46.74"	46.34"	46.44"
60"	58.49"	58.74"	58.34"	58.44"
72"	70.49"	70.74"	70.34"	70.44"
84"	82.49"	82.74"	82.34"	82.44"
96"	94.49"	94.74"	94.34"	94.44"



VERS-GRAZER (04) STATIC WHITE

24VDC Linear Fixtures - Surface & Recessed

COMPATIBLE POWER SUPPLIES

See power supplies cut sheets for more information. Data subject to change, all data has +/- 5% tolerance.

DIM TO LEVEL	INDOOR		OUTDOOR	
	SW24/1.5-4.0	SW24/5.0, SW-HE, SW-HE+	SW24/1.5-4.0	SW24/5.0, SW-HE, SW-HE+
Dim to Black	Q6M-DC+CAP QTM-DC+CAP IQ-PH IQ-PH+QD1	Q6M-DC+CAP QTM-DC+CAP IQ-PH IQ-PH+QD1	QOM-DC+CAP QOM-PH	QOM-DC+CAP QOM-PH
0.1%	QT-CAB-QZ-PH/0-10V QT-CAB-eLED+0-10V QT-CAB-eLED+0-10V-AWN QT-CAB-eLED+DALI-DT6 QT-CAB-eLED+DALI-DT6-AWN QTM-eLED+0-10V QTM-eLED+0-10V-AWN QTM-eLED+DALI-DT6 QTM-eLED+DALI-DT6-AWN QZ-BOWTIE+DIMMER QZ-DMX QZ-PH/0-10V QZ-STICK-PH/0-10V QZLP	QT-CAB-QZ-PH/0-10V QT-CAB-eLED+0-10V QT-CAB-eLED+0-10V-AWN QT-CAB-eLED+DALI-DT6 QT-CAB-eLED+DALI-DT6-AWN QTM-eLED+0-10V QTM-eLED+0-10V-AWN QTM-eLED+DALI-DT6 QTM-eLED+DALI-DT6-AWN QZ-BOWTIE+DIMMER QZ-DMX QZ-PH/0-10V QZ-STICK-PH/0-10V QZLP	Q-SET-QZ-DMX Q-SET-QZ-PH/0-10V Q-SET-eLED+0-10V QOM-eLED+0-10V QOM-eLED+DALI-DT6 QOM-eLED+PS-DALI-DT6 QZ-DMX QZ-PH/0-10V	Q-SET-QZ-DMX Q-SET-QZ-PH/0-10V Q-SET-eLED+0-10V QOM-eLED+0-10V QOM-eLED+DALI-DT6 QOM-eLED+PS-DALI-DT6 QZ-DMX QZ-PH/0-10V
1%	QTM-eLED(E) QZ-DALI-DT6	QTM-eLED(E) QZ-DALI-DT6	Q-SET+QZ-DALI-DT6 QZ-DALI-DT6	Q-SET+QZ-DALI-DT6 QZ-DALI-DT6
10%	Non-Dim Power Supply with SW App Dongle	Non-Dim Power Supply with SW App Dongle	Q-HEX-mini-DC Q-SET-mLED	







VERS-GRAZER (04) STATIC WHITE



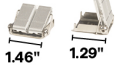

24VDC Linear Fixtures - Surface & Recessed

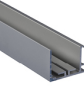
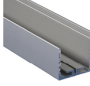
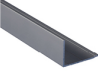
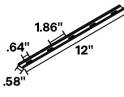
DIMMING PROTOCOL	INDOOR		OUTDOOR	
	SW24/1.5-4.0	SW24/5.0, SW-HE, SW-HE+	SW24/1.5-4.0	SW24/5.0, SW-HE, SW-HE+
Non-Dim	QT-CAB-eLED-ND QTM-eLED-ND QZ-ND	QT-CAB-eLED-ND QTM-eLED-ND QZ-ND	Q-SET-QZ-ND Q-SET-eLED-ND QOM-eLED-ND QZ-ND	Q-SET-QZ-ND Q-SET-eLED-ND QOM-eLED-ND QZ-ND
Phase	Q6M-DC+CAP QT-CAB-QZ-PH/0-10V QTM-DC+CAP QTM-eLED(E) QZ-BOWTIE+DIMMER QZ-PH/0-10V QZ-STICK-PH/0-10V QZLP iQ-PH iQ-PH+QD1	Q6M-DC+CAP QT-CAB-QZ-PH/0-10V QTM-DC+CAP QTM-eLED(E) QZ-BOWTIE+DIMMER QZ-PH/0-10V QZ-STICK-PH/0-10V QZLP iQ-PH iQ-PH+QD1	Q-HEX-mini-DC Q-SET-QZ-PH/0-10V Q-SET-mLED QOM-DC+CAP QOM-PH QZ-PH/0-10V	Q-SET-QZ-PH/0-10V QOM-DC+CAP QOM-PH QZ-PH/0-10V
0-10V	QT-CAB-QZ-PH/0-10V QT-CAB-eLED+0-10V QT-CAB-eLED+0-10V-AWN QTM-eLED+0-10V QTM-eLED+0-10V-AWN QZ-PH/0-10V QZ-STICK-PH/0-10V QZLP	QT-CAB-QZ-PH/0-10V QT-CAB-eLED+0-10V QT-CAB-eLED+0-10V-AWN QTM-eLED+0-10V QTM-eLED+0-10V-AWN QZ-PH/0-10V QZ-STICK-PH/0-10V QZLP	Q-SET-QZ-PH/0-10V Q-SET-eLED+0-10V QOM-eLED+0-10V QZ-PH/0-10V	Q-SET-QZ-PH/0-10V Q-SET-eLED+0-10V QOM-eLED+0-10V QZ-PH/0-10V
Lutron Athena	QT-CAB-eLED+0-10V-AWN QT-CAB-eLED+DALI-DT6-AWN QTM-eLED+0-10V-AWN QTM-eLED+DALI-DT6-AWN	QT-CAB-eLED+0-10V-AWN QT-CAB-eLED+DALI-DT6-AWN QTM-eLED+0-10V-AWN QTM-eLED+DALI-DT6-AWN		
ECO System	QTM-eLED(E)	QTM-eLED(E)		
DMX	QZ-DMX	QZ-DMX	Q-SET-QZ-DMX QZ-DMX	Q-SET-QZ-DMX QZ-DMX
DALI-2: DT6	QT-CAB-eLED+DALI-DT6 QT-CAB-eLED+DALI-DT6-AWN QTM-eLED+DALI-DT6 QTM-eLED+DALI-DT6-AWN QZ-DALI-DT6	QT-CAB-eLED+DALI-DT6 QT-CAB-eLED+DALI-DT6-AWN QTM-eLED+DALI-DT6 QTM-eLED+DALI-DT6-AWN QZ-DALI-DT6	Q-SET+QZ-DALI-DT6 QOM-eLED+DALI-DT6 QZ-DALI-DT6	Q-SET+QZ-DALI-DT6 QOM-eLED+DALI-DT6 QZ-DALI-DT6
SCENE App Dimmed	Non-Dim Power Supply with SW App Dongle	Non-Dim Power Supply with SW App Dongle		

COMPATIBLE MOUNTING ACCESSORIES

HINGE - HMB-M  1.41" .71" Adjustable mounting bracket - Medium	HINGE - HMB-L  1.46" 1.29" Adjustable mounting bracket - Large	HINGE - HMB-XL  4" 1.46" Adjustable mounting bracket - XLarge	Q-PIVOT  .75" 1.03" Small mounting accessory	Q-ANGLE  2.23" 1.38" Adjustable mounting accessory	NU-GRAZER  U Mounting Bracket	NJ-GRAZER  J Mounting Bracket	BL-GRAZER  Backwards L Mounting Bracket	MMA-02  1.86" .64" .58" 12" Magnet Mount Accessory for MG-02
--	--	---	--	--	---	--	---	--

COMPATIBLE WIRING ACCESSORIES

Q-mini-J  2" 1.25" UL Listed, miniature junction box, DRY/DMP (WET rated with silicone)	Q-mini-J5  2.80" 2.27" UL Listed, miniature junction box, DRY/DMP (WET rated with silicone)	CON120-EXT  10ft Con cable extender DRY/DMP/WET	CON FOUR-FER  Splits lead from one to four LED Con connectors DRY/DMP/WET	CON M - BARREL F  Male con to barrel cable adaptor DRY/DMP
---	---	--	--	---



VERS-GRAZER (04) STATIC WHITE

24VDC Linear Fixtures - Surface & Recessed

COMPATIBLE CONTROL ACCESSORIES

SCENE APP DONGLE



Wi-Fi or Bluetooth
Connectivity

COMPATIBLE APPS

NFC APP



Read and write
DMX addresses and
adjust voltage