

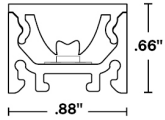

VERS-OPTICS (05) FOR TUNABLE APPLICATIONS

24VDC Linear Fixtures - Surface & Recessed

1 PRODUCT - DIMENSIONS



Profile with 40D lens

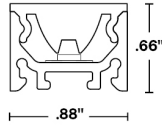

Profile with 50D lens

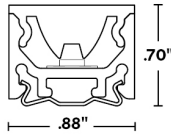

Profile with concealed clip

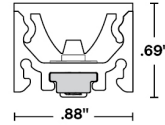

Profile with magnetic clip

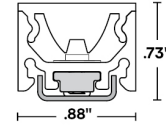

Profile with magnet mount clip & magnetic mount accessory

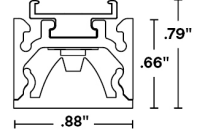

Profile with TBC-03

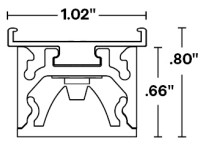

Profile with TBC-04

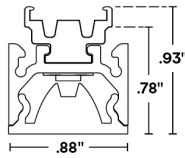

Profile with TBC-05

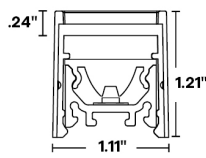

Profile with louver

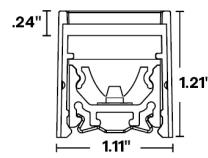

Profile with concealed clip and louver

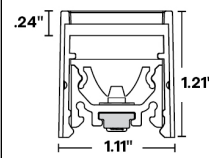

Profile with magnet mount clip and louver

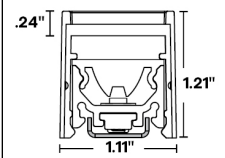

Profile with magnet mount clip, magnetic mount accessory & louver

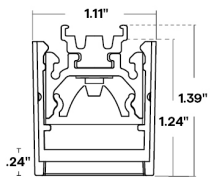

Profile with TBC-05 & louver

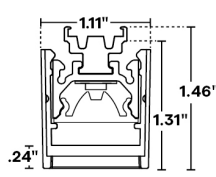

Profile with TBC-06 & louver

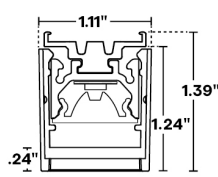

Profile with TBC-07 & louver

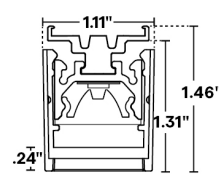

Profile with TBC-08 & louver

2 DELIVERED LUMENS

[Calculated L70 = 70000 hrs]

Tested with VERS-05-DW-***-DRY

	1.5HE W/FT		2.5HE W/FT		4.0HE W/FT	
	LM/FT	CRI	LM/FT	CRI	LM/FT	CRI
40D	159	98	247	98	384	98
50D	163	98	258	98	398	98

5 DIODE VISIBILITY



Optical lens

PHOTOMETRIC PERFORMANCE

Nominal beam spread shown, beam spread varies based on light engine. For more detailed information, see photometric data.

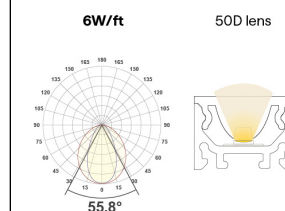
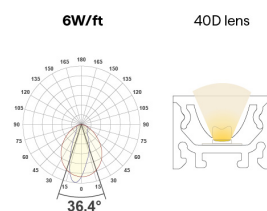



VERS-OPTICS (05) FOR TUNABLE APPLICATIONS

24VDC Linear Fixtures - Surface & Recessed

TEMPERATURE RATINGS

		DW 1.5 HE W/FT		DW 3.0 HE W/FT		DW 2.5 HE W/FT		DW 5.0 HE W/FT		DW 4.0 HE W/FT		DW 8.0 HE W/FT	
		QTL power supply other than DALI, DMX		DALI, DMX, or non-QTL power supply		QTL power supply other than DALI, DMX		DALI, DMX, or non-QTL power supply		QTL power supply other than DALI, DMX		DALI, DMX, or non-QTL power supply	
		Min	Max	Min	Max	Min	Max	Min	Max	Min	Max	Min	Max
DRY	Ambient Operating Temp - Surface	-4°F	145°F	-4°F	135°F	-4°F	135°F	-4°F	120°F	-4°F	125°F	-4°F	110°F

6 EXTERNAL LOUVER

PLASTIC

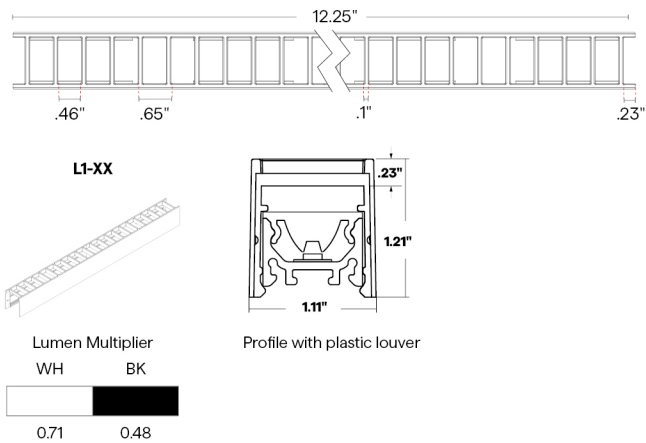

METAL

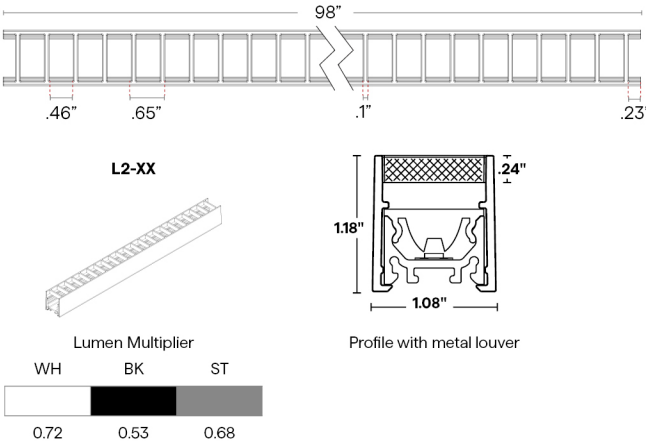

7 WIRE INPUT/OUTPUT

SINGLE (Input only)

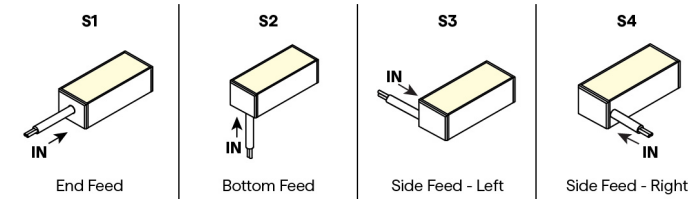

PASS THROUGH (Input/Output)

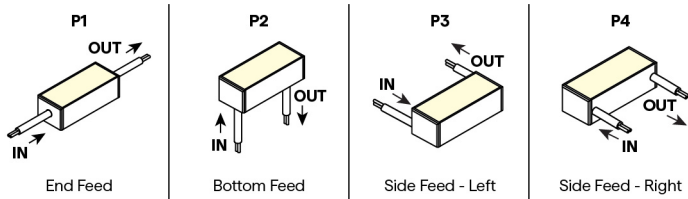



VERS-OPTICS (05) FOR TUNABLE APPLICATIONS

24VDC Linear Fixtures - Surface & Recessed

CONFIGURATION OPTIONS



8 / 9 CONNECTOR/WIRE - IN/OUT

Connector/Wire In or Out not needed to specify product.

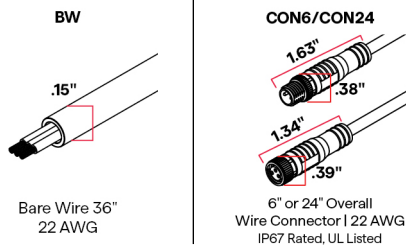

10 WIRE COLOR



12 MOUNTING

<p>CC (CC-01)</p> <p>Concealed Clip</p> <p>2 pieces of hardware provided for 4' or less; 4 pieces of hardware provided for greater than 4'</p> <p>To order separately use CC-01 (sold in pairs)</p> <p>Each clips comes with a #4 x 5/8" Flat Head screw.</p>	<p>CC (CC-02)</p> <p>Louver Concealed Clip Required if L1 or L2 Louver is selected</p> <p>2 pieces of hardware provided for 4' or less; 4 pieces of hardware provided for greater than 4'</p> <p>To order separately use CC-02 (sold in pairs)</p> <p>Each clips comes with a #4 x 5/8" Flat Head screw.</p>	<p>MG</p> <p>Magnet Clip</p> <p>One MG provided per foot</p> <p>To order separately use MG-02</p>	<p>MMA-02</p> <p>Magnet Mount Accessory for MG-02</p> <p>Sold separately, to order use MMA-02</p> <p>Each clip comes with a #6 Flat Screw</p> <p>Required when mounting to a non-magnetic surface</p>	<p>TBC-03</p> <p>Plastic T-Bar Clip</p> <p>Use on 9/16" Flat Drop Ceiling</p> <p>2 clips provided for first 12"; 1 clip provided for each additional 12" or less length. 1 T-Bar Mounting Jig included with each fixture.</p> <p>To order separately use TBC-03</p> <p>Each pair of clips comes with M2.5 x 4mm set screw and Allen key</p>
--	---	--	--	--



VERS-OPTICS (05) FOR TUNABLE APPLICATIONS

24VDC Linear Fixtures - Surface & Recessed

MOUNTING CONTINUED

<p>TBC-04</p>  <p>Plastic T-Bar Clip</p> <p>Use on 15/16" Flat or Tegular Drop Ceiling</p> <p>2 clips provided for first 12"; 1 clip provided for each additional 12" or less length. 1 T-Bar Mounting Jig included with each fixture.</p> <p>To order separately use TBC-04</p> <p>Each pair of clips comes with M2.5 x 4mm set screw and Allen key</p>	<p>TBC-05</p>  <p>Plastic T-Bar Clip</p> <p>Use on 9/16" Tegular Drop Ceiling</p> <p>2 clips provided for first 12"; 1 clip provided for each additional 12" or less length. 1 T-Bar Mounting Jig included with each fixture.</p> <p>To order separately use TBC-05</p> <p>Each pair of clips comes with M2.5 x 4mm set screw and Allen key</p>	<p>TBC-06</p>  <p>Plastic T-Bar Clip</p> <p>Use with Louver on 9/16" Tegular Drop Ceiling</p> <p>2 clips provided for first 12"; 1 clip provided for each additional 12" or less length. 1 T-Bar Mounting Jig included with each fixture.</p> <p>To order separately use TBC-06</p> <p>Each pair of clips comes with M2.5 x 4mm set screw and Allen key</p>	<p>TBC-07</p>  <p>Plastic T-Bar Clip</p> <p>Use with Louver on 15/16" Flat Drop Ceiling</p> <p>2 clips provided for first 12"; 1 clip provided for each additional 12" or less length. 1 T-Bar Mounting Jig included with each fixture.</p> <p>To order separately use TBC-07</p> <p>Each pair of clips comes with M2.5 x 4mm set screw and Allen key</p>	<p>TBC-08</p>  <p>Plastic T-Bar Clip</p> <p>Use with Louver on 15/16" Tegular Drop Ceiling</p> <p>2 clips provided for first 12"; 1 clip provided for each additional 12" or less length. 1 T-Bar Mounting Jig included with each fixture.</p> <p>To order separately use TBC-08</p> <p>Each pair of clips comes with M2.5 x 4mm set screw and Allen key</p>
--	---	---	---	--

13 FINISH

	Satin
	Black
	Bronze
	White

Custom finishes require a longer lead time, consult factory

15 EXACT/OPTIMAL FIXTURE LENGTH

Exact fixtures are the exact length specified. Optimal fixtures' length is rounded down based on LED cut points to allow the fixture to be illuminated end to end. For runs with multiple fixtures that need to fill a specific length, it's recommended to order all optimal fixtures with an exact fixture at the end of the run.





VERS-OPTICS (05) FOR TUNABLE APPLICATIONS

24VDC Linear Fixtures - Surface & Recessed

DW-HE DRY LENGTHS BY INCH

EXACT LENGTH

Requested Length	Potential dim spot on either end of a S1 fixture
	S1  End Feed
12"	1"
13"	0.5"
14"	1"
15"	0.5"
16"	1"
17"	0.5"
18"	1"
19"	0.5"
20"	1"
21"	0.5"
22"	1"
23"	0.5"
24"	1"
36"	1"
48"	1"
60"	1"
72"	1"
84"	1"
96"	1"

OPTIMAL LENGTH

Requested Nominal Length	S1 & S2  End Feed		P1 & P2  End Feed		S3 & S4  Side Feed - Left		P3 & P4  Side Feed - Left	
	S1	S2	P1	P2	S3	S4	P3	P4
12"		10.59"		10.94"		10.49"		10.59"
13"		12.59"		12.94"		12.49"		12.59"
14"		12.59"		12.94"		12.49"		12.59"
15"		14.59"		14.94"		14.49"		14.59"
16"		14.59"		14.94"		14.49"		14.59"
17"		16.59"		16.94"		16.49"		16.59"
18"		16.59"		16.94"		16.49"		16.59"
19"		18.59"		18.94"		18.49"		18.59"
20"		18.59"		18.94"		18.49"		18.59"
21"		20.59"		20.94"		20.49"		20.59"
22"		20.59"		20.94"		20.49"		20.59"
23"		22.59"		22.94"		22.49"		22.59"
24"		22.59"		22.94"		22.49"		22.59"
36"		34.59"		34.94"		34.49"		34.59"
48"		46.59"		46.94"		46.49"		46.59"
60"		58.59"		58.94"		58.49"		58.59"
72"		70.59"		70.94"		70.49"		70.59"
84"		82.59"		82.94"		82.49"		82.59"
96"		94.59"		94.94"		94.49"		94.59"

COMPATIBLE POWER SUPPLIES

See power supplies cut sheets for more information. Data subject to change, all data has +/- 5% tolerance.

DIM TO LEVEL	INDOOR
	DW-HE Tunable Applications
0.1%	QT-CAB-eLED+DALI-DT6 QT-CAB-eLED+DALI-DT8 QT-CAB-eLED+DALI-DT8-AWN QT-CAB-eLED+TW QT-CAB-eLED+TW-AWN QTM-eLED+DALI-DT6 QTM-eLED+DALI-DT8 QTM-eLED+DALI-DT8-AWN QTM-eLED+TW QTM-eLED+TW-AWN QZ-DMX
1%	QZ-DALI-DT8
10%	Non-Dim Power Supply with TW App Dongle



VERS-OPTICS (05) FOR TUNABLE APPLICATIONS

24VDC Linear Fixtures - Surface & Recessed

DIMMING PROTOCOL	INDOOR
	DW-HE Tunable Applications
0-10V	QT-CAB-eLED+TW QT-CAB-eLED+TW-AWN QTM-eLED+TW QTM-eLED+TW-AWN
Lutron Athena	QT-CAB-eLED+DALI-DT8-AWN QT-CAB-eLED+TW-AWN QTM-eLED+DALI-DT8-AWN QTM-eLED+TW-AWN
DMX LED wattage must be doubled for DW-HE products	QZ-DMX
DALI-2: DT6 LED wattage must be doubled for DW-HE products except for AWN	QT-CAB-eLED+DALI-DT6 QTM-eLED+DALI-DT6
DALI-2: DT8 LED wattage must be doubled for DW-HE products except for AWN	QT-CAB-eLED+DALI-DT8 QT-CAB-eLED+DALI-DT8-AWN QTM-eLED+DALI-DT8 QTM-eLED+DALI-DT8-AWN QZ-DALI-DT8
SCENE App Dimmed	Non-Dim Power Supply with TW App Dongle

COMPATIBLE MOUNTING ACCESSORIES

HINGE - HMB-M

Adjustable mounting bracket - Medium

HINGE - HMB-L

Adjustable mounting bracket - Large

HINGE - HMB-XL

Adjustable mounting bracket - XLarge

Q-PIVOT

Small mounting accessory

Q-ANGLE

Adjustable mounting accessory

NJ-LARGE

J Mounting Bracket

NU-LARGE

U Mounting Bracket

SD-J-LARGE

J Mounting Bracket

BL-LARGE

Backwards L Mounting Bracket

NL-LARGE

L Mounting Bracket

SD-L-LARGE

L Mounting Bracket

MMA-02

Magnet Mount Accessory for MG-02

COMPATIBLE WIRING ACCESSORIES

Q-mini-J5

UL Listed, miniature junction box, DRY/DMP (WET rated with silicone)



VERS-OPTICS (05) FOR TUNABLE APPLICATIONS

24VDC Linear Fixtures - Surface & Recessed

COMPATIBLE CONTROL ACCESSORIES

SCENE APP DONGLE



Wi-Fi or Bluetooth
Connectivity

COMPATIBLE APPS

NFC APP



Read and write
DMX addresses and
adjust voltage