

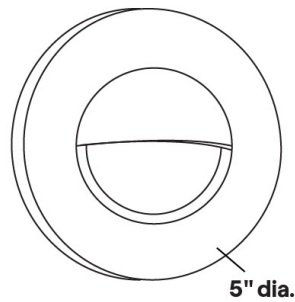

ST-14L

12VAC/DC MR16 9W LED Core Drill Step Light



- 6061 Marine Grade Aluminum, available in eight standard TGIC Free powder coat finishes
- Not compatible with electronic transformers.
- Tempered crystalline spread lens.
- 6 feet of 16/2 low voltage cable supplied.
- Listed for wet location use.
- Input Voltage: 10.8-13.2VAC/DC (remote transformer required)
- Socket: GU5.3 Bi Pin Porcelain
- Wet Listed
- Specification-grade, wet-location landscape luminaire for wall mounted fixed downlighting and uplighting applications.

ST-14L Shown in Bronze Texture Powder Coat Finish (BZT)

Dimensions: 5" dia. faceplate, 4 1/2" length

1	2	3	4	5	6	7
PRODUCT	MATERIAL	EYELID STYLE	FINISH	WATTAGE	CCT	LENS
ST-14L	A			9.0		

Sample Part Number: ST-14L-B-1-DB-9.0-30-30

1	2	3	4	5
PRODUCT	MATERIAL	EYELID STYLE	FINISH	WATTAGE
ST-14L	A Aluminum	1 1/2 Eyelid Style 2 3/4 Eyelid Style	BG Beige BB Black Bronze BK Black BKT Black Texture BZ Bronze BZT Bronze Texture SL Silver WH White	9.0 9.0W

6	7
CCT	LENS
27 2700K 30 3000K 40 4000K	15 15 Degree Lens 30 30 Degree Lens 45 45 Degree Lens 60 60 Degree Lens

5 year warranty | Warranty only valid with QTL power supplies | Field modifications void warranty | Data subject to change, all data has +/- 5% tolerance



ST-14L

12VAC/DC MR16 9W LED Core Drill Step Light

1

PRODUCT - DIMENSIONS

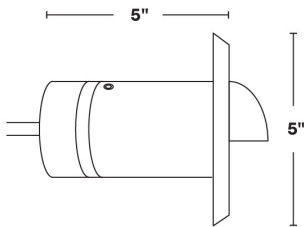
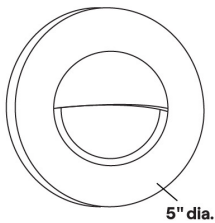

2

MATERIAL



Aluminum

4

FINISH

Eight Standard TGIC Free powder coat finish.



Beige

Black

Black Texture

Bronze



Bronze Texture

Black Bronze

Silver

White

COMPATIBLE POWER SUPPLIES

See power supplies cut sheets for more information. Data subject to change, all data has +/- 5% tolerance.

DIMMING PROTOCOL	OUTDOOR
	LANDSCAPE LIGHTING
Phase	Q-HEX Q-SET-1 Q-SET-2 Q-SET-3 QOMD QOMS



9W LED MODULE

MR16 LED MODULE

3 YEAR
WARRANTY



9W LED Module

- Equivalent to MR16 75W Halogen (equivalent CBCP)
- 2700K, 3000K, or 4000K
- 10.8-13.2V AC/DC
- 12W startup draw
- Interchangeable lens: 15°, 30°, 45°, 60°
- Compatible with low-voltage magnetic transformers
- Field replaceable

LED MODULE SPECIFICATIONS

WATTAGE	LENS	2700K	3000K	4000K
9W	15°, 30°, 45°, 60°	810 Lumens	835 Lumens	855 Lumens

LED LENS



15° Lens



30° Lens



45° Lens



60° Lens