



POSH
Field Assembled Extrusion - Closet Rod

SEE THIS EXTRUSION AS A FACTORY BUILT FIXTURE ▶



- Flexible sleeve consisting of a carrier and silicone cover to protect LED strips
- Available with frosted or diffused lens
- Comes in small, medium or large sizes to accommodate for different LED strip widths
- SHLD-A is a standalone version to use in place of extrusion and lens
- SHLD-B is used within aluminum extrusions to add additional diffusion, light loss factor dependent on diffusion levels

1	2	3	4	5	6
PRODUCT	FINISH	MOUNTING	LENS	WIRE INPUT/OUTPUT	EXTRUSION LENGTH (IN)
POSH			DF	NI	

Sample Part Number: POSH-ST-SB-DF-NI-48"

1	2	3
PRODUCT	FINISH	MOUNTING
POSH	<div><div>ST</div><div>BK</div><div>WH</div><div>CU</div><div>Satin</div><div>Black</div><div>White</div><div>Custom Color</div></div> <div>Custom finishes require a longer lead time, consult factory</div>	Refer to following pages for mounting clip option details and provided quantities.
4	5	6
LENS	WIRE INPUT/OUTPUT	EXTRUSION LENGTH (IN)
<div>DF</div> <div>Diffused</div> <div>For representation of LED visibility, see Diode Visibility section on following pages. For beam angles, see Photometric Performance section on following pages.</div>	<div>NI</div> <div>Not Installed</div>	1" increments from 1" - 98.43" Tolerance +0.0"/-0.5"

COMPATIBLE LED STRIPS

	STATIC WHITE (SW)	STATIC WHITE STANDARD (SD-SW)	STATIC WHITE HIGH EFFICACY (SW-HE)	STATIC WHITE HIGH EFFICACY PLUS (SW-HE+)	STATIC WHITE EXTREME TEMP (SW-XT)	STATIC WHITE DOUBLE ROW (SW-DR)	STATIC WHITE HIGH EFFICACY DOUBLE ROW (SW-HE-DR)	DYNAMIC WHITE HIGH EFFICACY (DW-HE)	WARM DIM (WD)	STATIC COLOR (SC)	RGB	RGBW	RGBW HIGH EFFICACY (RGBW-HE)
DRY	✓ W/FT: 15, 3.0, 4.0, 5.0	✓ W/FT: 10, 2.0, 4.0, 6.0	✓ W/FT: 15, 3.0, 6.0	✓ W/FT: 3.0, 6.0				✓ W/FT: 15, 2.5, 4.0	✓ W/FT: 6.0	✓ W/FT: 5.0	✓ W/FT: 6.0	✓ W/FT: 6.0	✓ W/FT: 4.0
DMP	✓ W/FT: 15, 3.0, 4.0, 5.0		✓ W/FT: 15, 3.0, 6.0					✓ W/FT: 15, 2.5		✓ W/FT: 5.0	✓ W/FT: 6.0	✓ W/FT: 6.0	✓ W/FT: 4.0
ENC											✓ W/FT: 6.0		
WET	✓ W/FT: 15, 3.0, 4.0, 5.0	✓ W/FT: 10, 2.0, 4.0	✓ W/FT: 15, 3.0, 6.0	✓ W/FT: 3.0, 6.0	✓ W/FT: 3.0			✓ W/FT: 15, 2.5	✓ W/FT: 6.0	✓ W/FT: 5.0		✓ W/FT: 6.0	

Field modifications must comply with QTL's installation methods otherwise warranty is null & void | Surface mount | Painted end caps match the extrusion finish and have a white painted interior. Satin end caps utilize a metallic paint



POSH

Field Assembled Extrusion - Closet Rod

SEE THIS EXTRUSION AS A FACTORY BUILT FIXTURE ▶

1 PRODUCT - DIMENSIONS



Profile

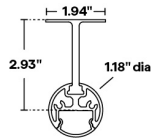

Profile with support

END CAPS

One pair of end caps is provided with each length of extrusion ordered.

Flat end caps

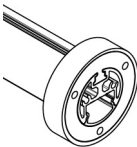

Feed

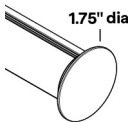

No feed

WALL TO WALL
Endplate and Screw on canopy

FLOAT
Endcap has no hole as it should be an S2/rear exit feed

2 FINISH

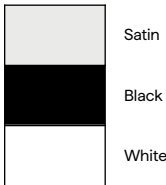

Champagne

3 MOUNTING

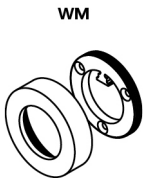

Mounting Plate and Cover for Wall to Wall

WALL TO WALL
No support brackets provided for 4' or less. 2 supports provided for 4'-6'; SB's to be used spaced evenly up to 2'. 3 supports provided for 6'-8' SB to be used spaced evenly up to 2'.

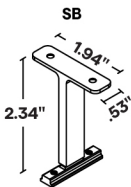

Closet Rod Support Bracket

FLOAT
SB to be used spaced evenly up to 2'. If spacing is larger than 2', add another support bracket. 2 support brackets provided for 6' or less; 3 support brackets provided greater than 6' spaced evenly

4 DIODE VISIBILITY



DF - Diffused lens