

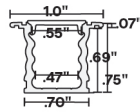

FLUR™

Field Assembled Extrusion - Recessed

SEE THIS EXTRUSION AS A FACTORY BUILT FIXTURE ►

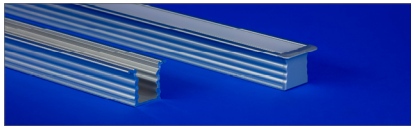

- Flanged extrusion for surface or recess mounting
- Pair with an optional mounting tray and a clear lens for a 45°, 60°, or 80° cutoff
- Combine with White Optics to increase light output between 5-47%*

1	2	3	4	5	6
PRODUCT	FINISH	MOUNTING	LENS	WIRE INPUT/OUTPUT	EXTRUSION LENGTH (IN)
		SST		NI	

Sample Part Number: **FLUR-BK-SST-PR-NI-48"**

1	PRODUCT	2	FINISH	3	MOUNTING
FLUR FLUR-WO WO - WhiteOptics (Internal coating, greater lumen output)		ST Satin BK Black CU Custom Color Custom finishes require a longer lead time, consult factory		SST Stainless Steel Refer to following pages for mounting clip option details and provided quantities.	
4	LENS	5	WIRE INPUT/OUTPUT	6	EXTRUSION LENGTH (IN)
DF Diffused PR Polar FR Frosted CL/45 Clear 45° CL/60 Clear 60° CL/80 Clear 80° For representation of LED visibility, see Diode Visibility section on following pages. For beam angles, see Photometric Performance section on following pages.		NI Not Installed		1" increments from 1" - 98.43" Tolerance +0.0"/-0.5"	

COMPATIBLE LED STRIPS

	STATIC WHITE (SW)	STATIC WHITE STANDARD (SD-SW)	STATIC WHITE HIGH EFFICACY (SW-HE)	STATIC WHITE HIGH EFFICACY PLUS (SW-HE+)	STATIC WHITE EXTREME TEMP (SW-XT)	STATIC WHITE DOUBLE ROW (SW-DR)	STATIC WHITE HIGH EFFICACY DOUBLE ROW (SW-HE-DR)	DYNAMIC WHITE HIGH EFFICACY (DW-HE)	WARM DIM (WD)	STATIC COLOR (SC)	RGB	RGBW	RGBW HIGH EFFICACY (RGBW-HE)
DRY	✓ W/FT: 1.5, 3.0, 4.0, 5.0	✓ W/FT: 1.0, 2.0, 4.0, 6.0	✓ W/FT: 1.5, 3.0, 6.0, 9.0	✓ W/FT: 3.0, 6.0				✓ W/FT: 1.5, 2.5, 4.0	✓ W/FT: 6.0	✓ W/FT: 5.0	✓ W/FT: 6.0		✓ W/FT: 4.0, 8.0 NO CLEAR LENS
DMP	✓ W/FT: 1.5, 3.0, 4.0, 5.0		✓ W/FT: 1.5, 3.0, 6.0					✓ W/FT: 1.5, 2.5, 4.0	✓ W/FT: 6.0	✓ W/FT: 5.0	✓ W/FT: 6.0		✓ W/FT: 4.0 NO CLEAR LENS
ENC	✓ W/FT: 1.5, 3.0, 4.0, 5.0		✓ W/FT: 1.5, 3.0, 6.0					✓ W/FT: 1.5, 2.5		✓ W/FT: 5.0	✓ W/FT: 6.0		✓ W/FT: 4.0
WET	✓ W/FT: 1.5, 3.0, 4.0, 5.0	✓ W/FT: 1.0, 2.0, 4.0								✓ W/FT: 5.0			

Field modifications must comply with QTL's installation methods otherwise warranty is null & void | Recess mount with adhesive only | Painted end caps match the extrusion finish and have a white painted interior. Satin end caps utilize a metallic paint. | Patent # D798,471 S

**FLUR™**

Field Assembled Extrusion - Recessed

SEE THIS EXTRUSION AS A FACTORY BUILT FIXTURE ▶

1 PRODUCT - DIMENSIONS

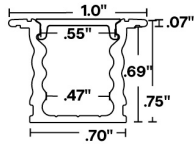

Profile

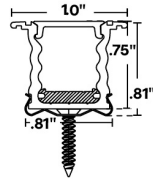

Profile with stainless steel mounting clip and mounting tray

END CAPS

One pair of end caps is provided with each length of extrusion ordered.

Flat end caps

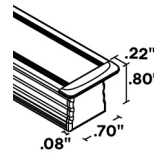

No feed

To order separately, use FLUR-EC

WHITEOPTICS® PHOTOMETRICS

[Calculated L70(6k) - 70000 hours] Tested with SW24/5.0-DRY-30

	FLUR LM/FT		FLUR-WO LM/FT		FLUR-WO Lumen Increase	
	Satin	Black	Satin	Black	Satin	Black
Clear	307	246	322	300	5%	22%
Frosted	259	196	286	258	10%	32%
Polar	227	163	266	230	17%	41%
Diffused	198	127	219	187	11%	47%

2 FINISH



Satin

Black

Custom finishes require a longer lead time, consult factory

3 MOUNTING

SST

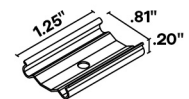

Stainless Steel Clip

2 clips provided for 4' or less; 4 clips provided for greater than 4'

To order separately use SST-01

Each clip comes with a #4 x 5/8" Flat Head SS

4 DIODE VISIBILITY



DF - Diffused lens

PR - Polar lens

FR - Frosted lens

CL - Clear lens

PHOTOMETRIC PERFORMANCE

Nominal beam spread shown, beam spread varies based on light engine. For more detailed information, see factory built fixture photometric data.

CL/45



Clear 45°

CL/60

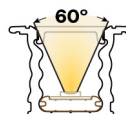

Clear 60°

CL/80

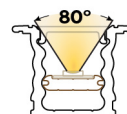

Clear 80°

COMPATIBLE ACCESSORIES

HINGE - HMB-M



Adjustable mounting bracket - Medium

HINGE - HMB-L

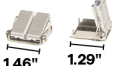

Adjustable mounting bracket - Large

HINGE - HMB-XL



Adjustable mounting bracket - XLarge

Q-PIVOT



Small mounting accessory

Q-ANGLE



Adjustable mounting accessory

VHB



Double sided mounting tape